

notes and symbols

plan symbols

room tag: room name room number

elevation tag: elevation ref. sheet ref.

section tag: section ref. sheet ref.

detail tag: detail ref. sheet ref.

ALIGN: Align finished face of partition with surfaces indicated.

Existing construction to remain

Existing construction to be demolished

furniture plan general notes

Furniture plan is not for construction. Plan reflects furniture layout and is for coordination purposes only. Installation of furniture is designated by vendor's installation plans.

Owner and/or contractor supplied equipment is shown for coordination only. Verify and coordinate clear dimensions required for Owner furnished equipment located within or adjacent to casework.

Furniture systems power shown for coordination only. Reference engineer drawings for actual locations of all power and communications.

Systems furniture power where provided is installed by furniture vendor. Contractor is responsible for connection of power whips to building power.

All cabling and termination of cables in systems furniture is not provided by furniture vendor.

Furniture vendor is responsible for removing from the job site all trash and packaging materials that relate to furniture product.

Coordinate and install blocking as required for any wall-mounted furniture and fixtures specified.

Install all ceiling wall-mounted equipment with 80" clear below.

power-data & core drill coordination

Connect vendor provided electrical whip to shell building at designated locations. Furniture vendor shall install whip to the furniture system and shall install all electrical components within furniture systems.

Cabling contractor to install all cable from shell building to furniture system and within panels to the termination point, including the receptacle.

Locations of core drills are shown for coordination with furniture. Verify locations related to any shell building restraints or conflicts, including but not limited to the following: structural systems - post tensioned cables, beams, etc., MPE system located below slab - piping, ductwork, cabling, electrical.

If discrepancies or conflicts are discovered with the core drill locations, the contractor shall notify the furniture vendor immediately for clarification and resolution.

The assumptions used in locating the core drill are as follows: Four workstations per one electrical power feed, eight workstations per one cable feed, core drill/floor device faceplate does not exceed 8" in diameter, minimum distance between core drills is 24".

Core drill coordination: Submit cut-sheet of each type of floor box to be installed in space. Include dimensions of faceplate and floor penetration and locations of each type of box. Designate power verses data selections.

keynotes

furniture keynotes

Contractor shall perform the work indicated by these notes in areas designated on the plan specific keynote number.

1. Location of wall tracks to be mounted to wall per manufacturer's instructions. Provide 1/4" plywood from finished floor to 63" AFF.
2. furniture keynote line
3. furniture keynote line
4. furniture keynote line
5. furniture keynote line

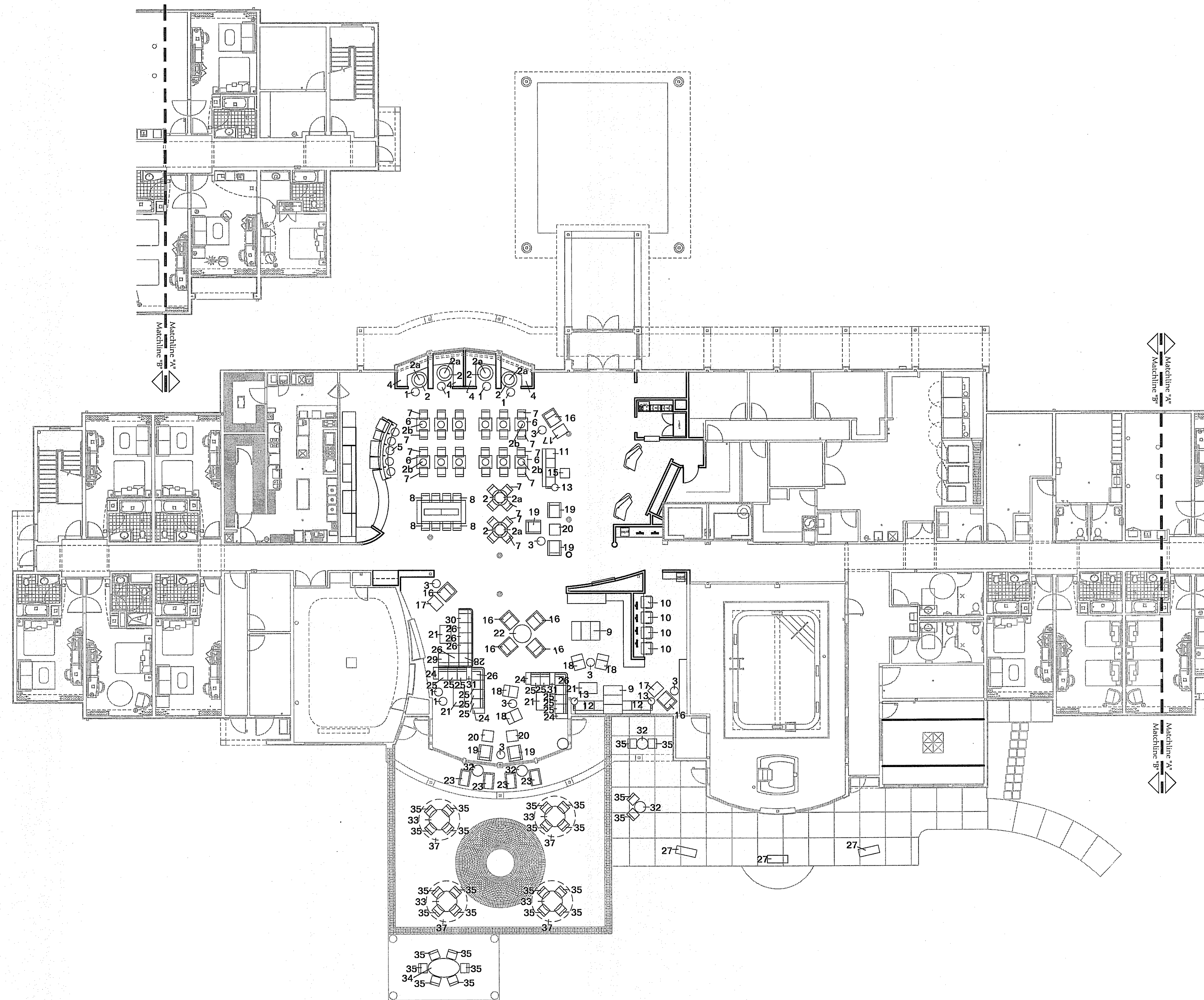

Furniture Plan

803 S. MOUNT MORIAH
SUITE 100B
MEMPHIS, TN 38117
(901) 683-7175 p.
(901) 683-2385 f.
llw@llwarchitects.com

NO.	ISSUED	DATE

COPYRIGHT BY LLW ARCHITECTS, INC.
WARNING: UNAUTHORIZED COPYING VIOLATES
U.S. COPYRIGHT LAWS AND WILL SUBJECT THE
VIOLATOR TO LEGAL PROSECUTION.

CONSULTANTS

STRUCTURAL:
S.K. INTERNATIONAL
(256) 852-3098

MECHANICAL:
HARRISON FRENCH
(479) 273-7780

PLUMBING
HARRISON FRENCH
(479) 273-7780

ELECTRICAL:
HARRISON FRENCH
(479) 273-7780

SEAL

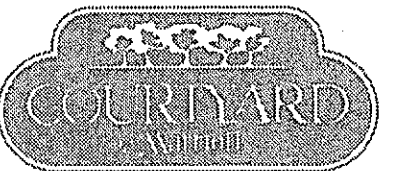

VICKSBURG,
MISSISSIPPI

SHEET NAME

Furniture Plan

DATE
8/26/08

DRAWN BY

CHECKED BY

FILE NAME

SCALE
As Noted

PROJECT NO.
1505

DRAWING

1A1.3