

6800 S Creek Rd, Charlotte, NC 28277
Ph: (704) 625-6554 Fax: (704) 919-5822
EMAIL: ashish@mishnaarch.com
WEB: www.mishnaarch.com

CNVL:
David Lane Beard & Associates, Inc.
105 Commercial Parkway
West Monroe, LA 71294
Phone: (318) 388-3227
Email: gadberry@dlbengineering.com

STRUCTURAL:
WGPM, Inc.
11220 Elm Lane, Suite 201
Charlotte, NC 28277
Phone: (704) 542-7199
Fax: (704) 542-7195
Email: lwright@wgpminc.com

R. Shane Ritter, PE
1043 Arroyo Vista Lane
Matthew, NC 28014
Phone: (704) 516-0385
Email: shane@rittereng.com
Project Number: 12015

Shultz Engineering Group, P.C.
212 North McDowell St., Suite 204
Charlotte, NC 28204
Phone: (704) 334-7363
Fax: (704) 347-0093
Email: don@shultzeg.com

[illegible]

Information contained on this drawing and in all digital files associated is authorized for use on the project named herein only and is the property of MISHRA ARCHITECTURE PLLC and may not be reproduced in any manner without express written or verbal permission from authorized individuals. Original drawing is 24"x36" and scales are as indicated. © 2011 MISHRA ARCHITECTURE PLLC

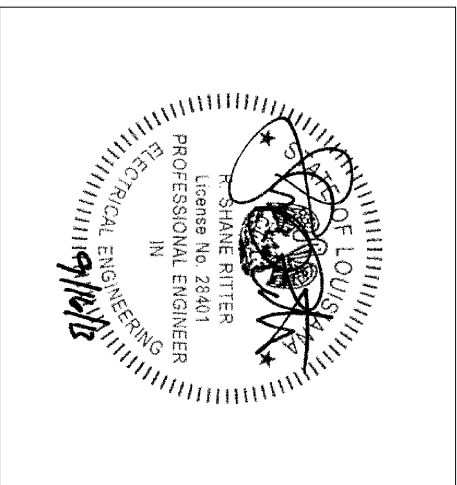

KEY PLAN

**Southern Hospitality
Services**

Hampton Inn and Suites

5400 I-20 & Frontage Rd.
Monroe, LA 71201

Drawing Title
Electrical Systems Details

Phase	Construction Documents
Project No.	12-111
Prepared by	RSR
Checked by	RSR
Date	Sept. 16, 2013

Released for
PERMIT ONLY

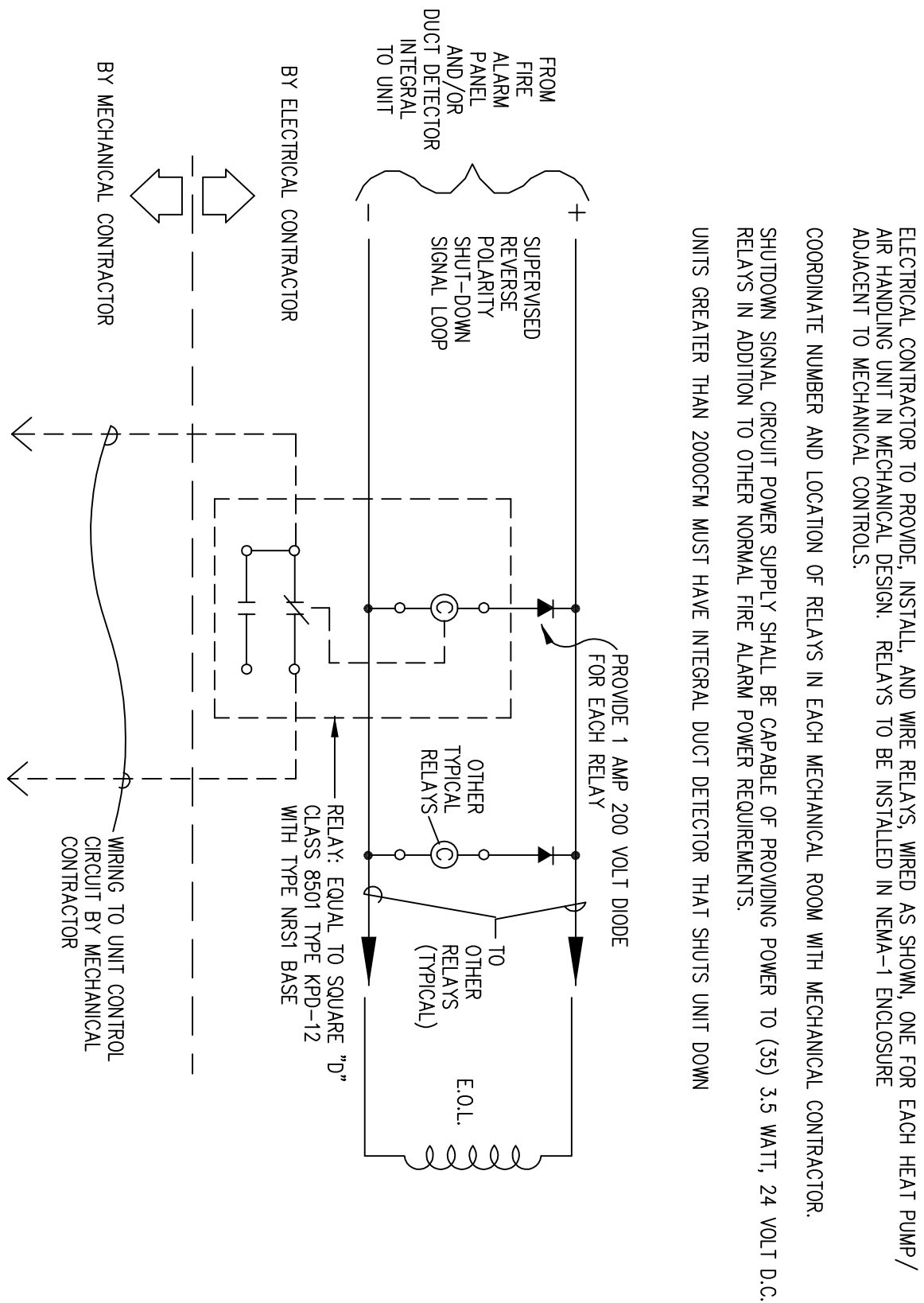

2		AL
(E6.3)	SCALE: NO SCALE	

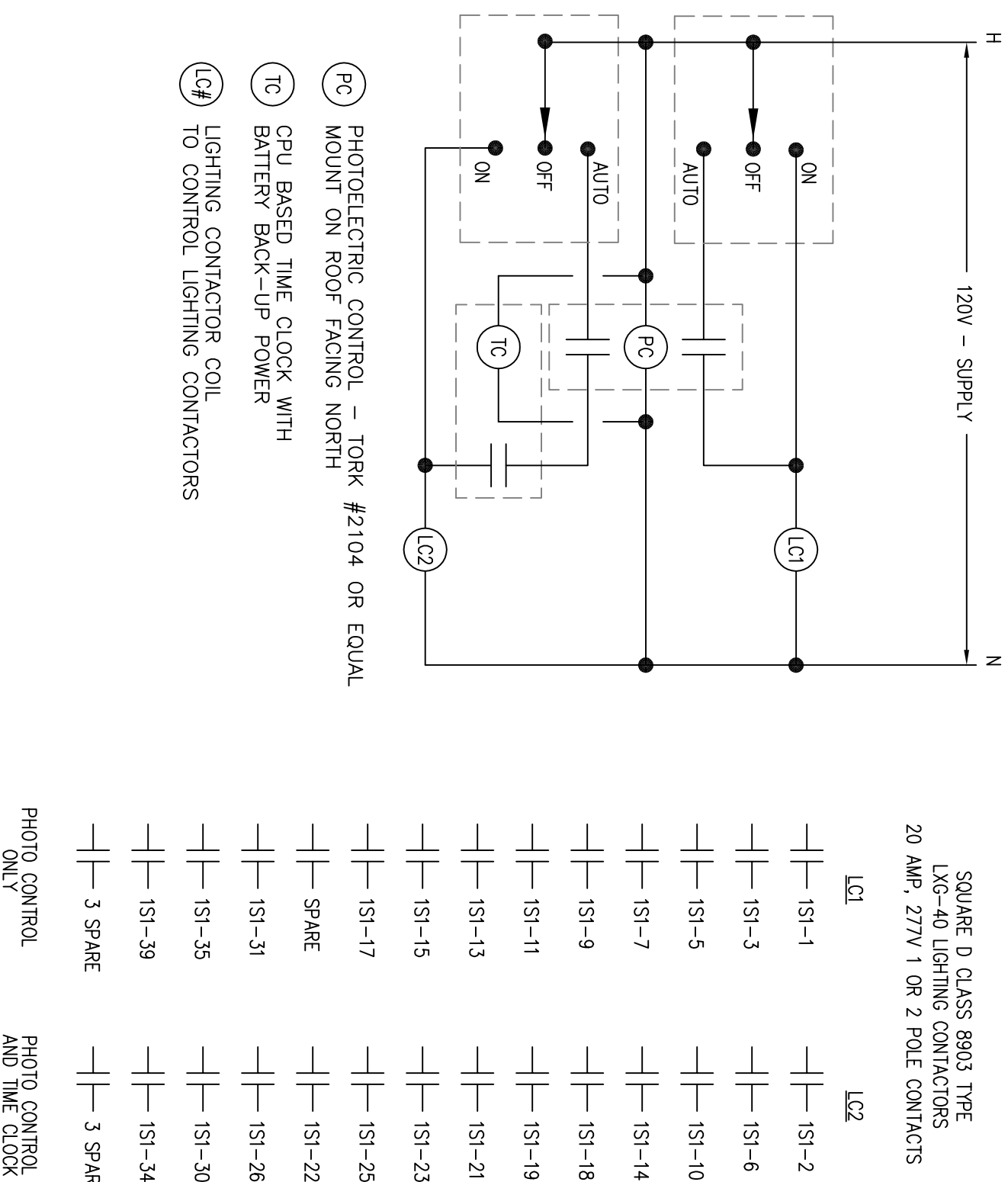

4
E6.3

SCALE: NO SCALE

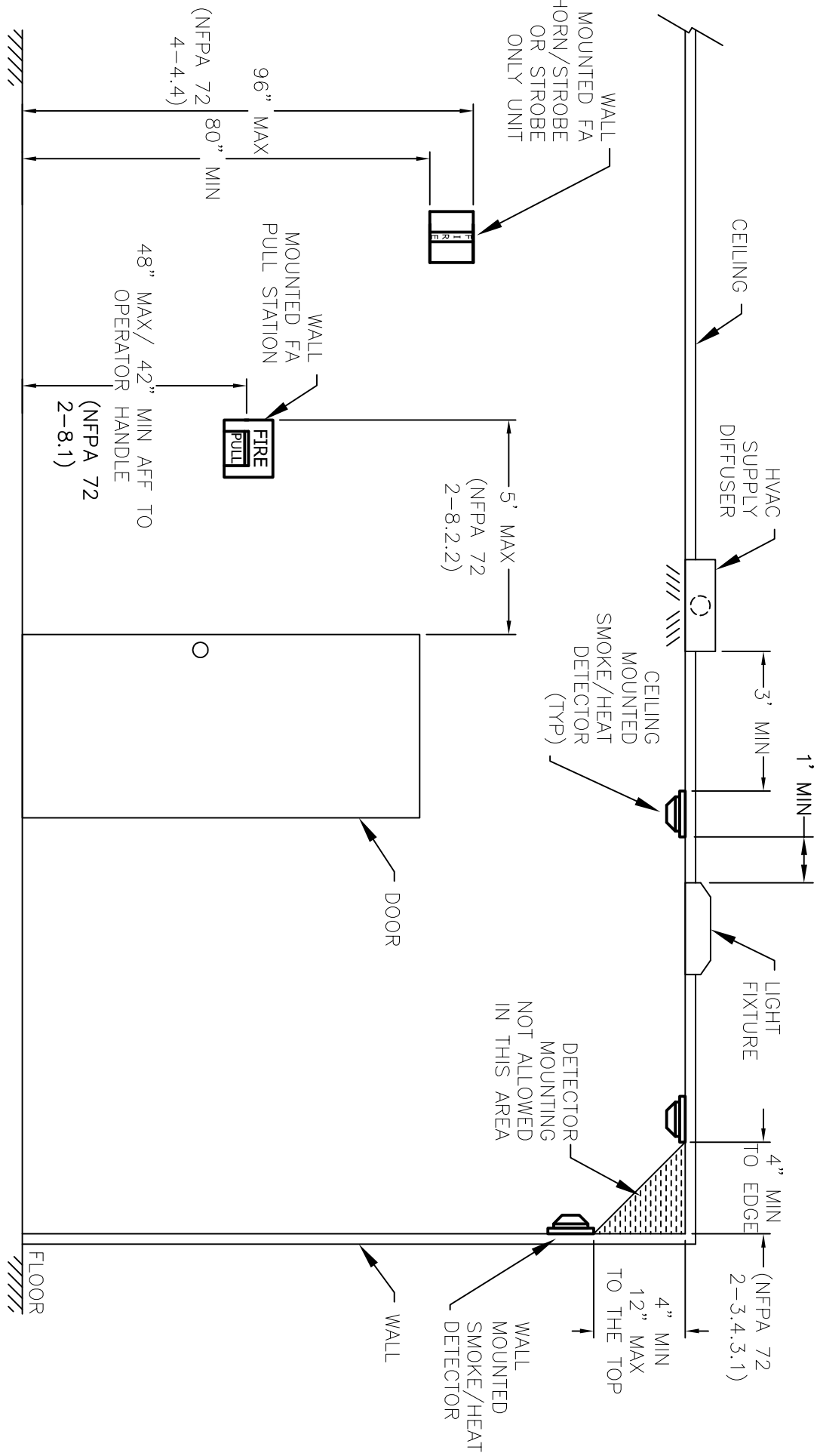

1		AL
(E6.3)	SCALE: NO SCALE	

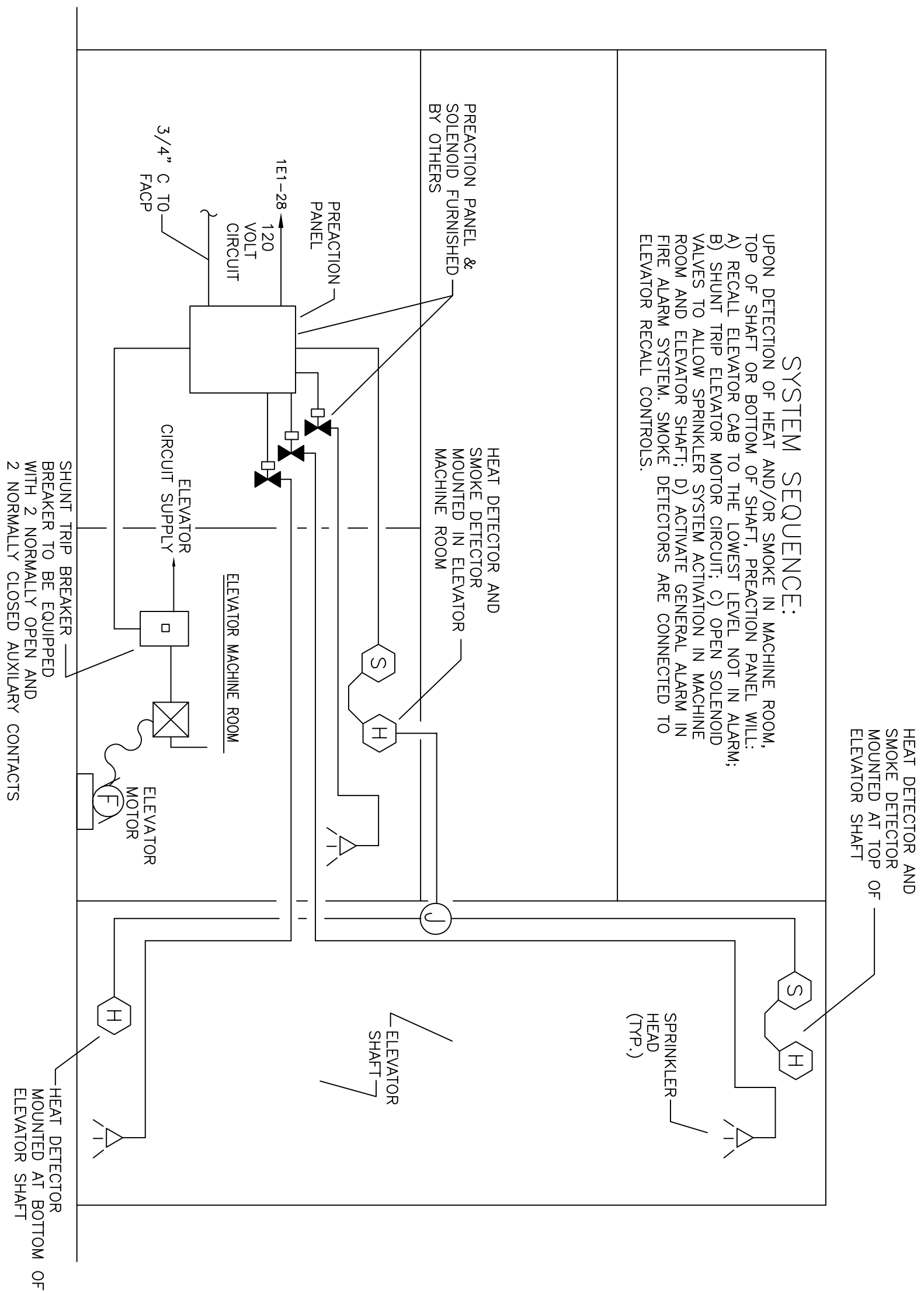

SCALE: NO SCALE

E6.3

SCALE: NO SCALE

Sheet No. _____

Project No. 12-111

Prepared by RSR

Checked by RSR

Date Sept. 16, 2013

E6.3