

**1 PLAN @ FITNESS CENTER**  
 1/4" = 1'-0"  
 AX-X-X

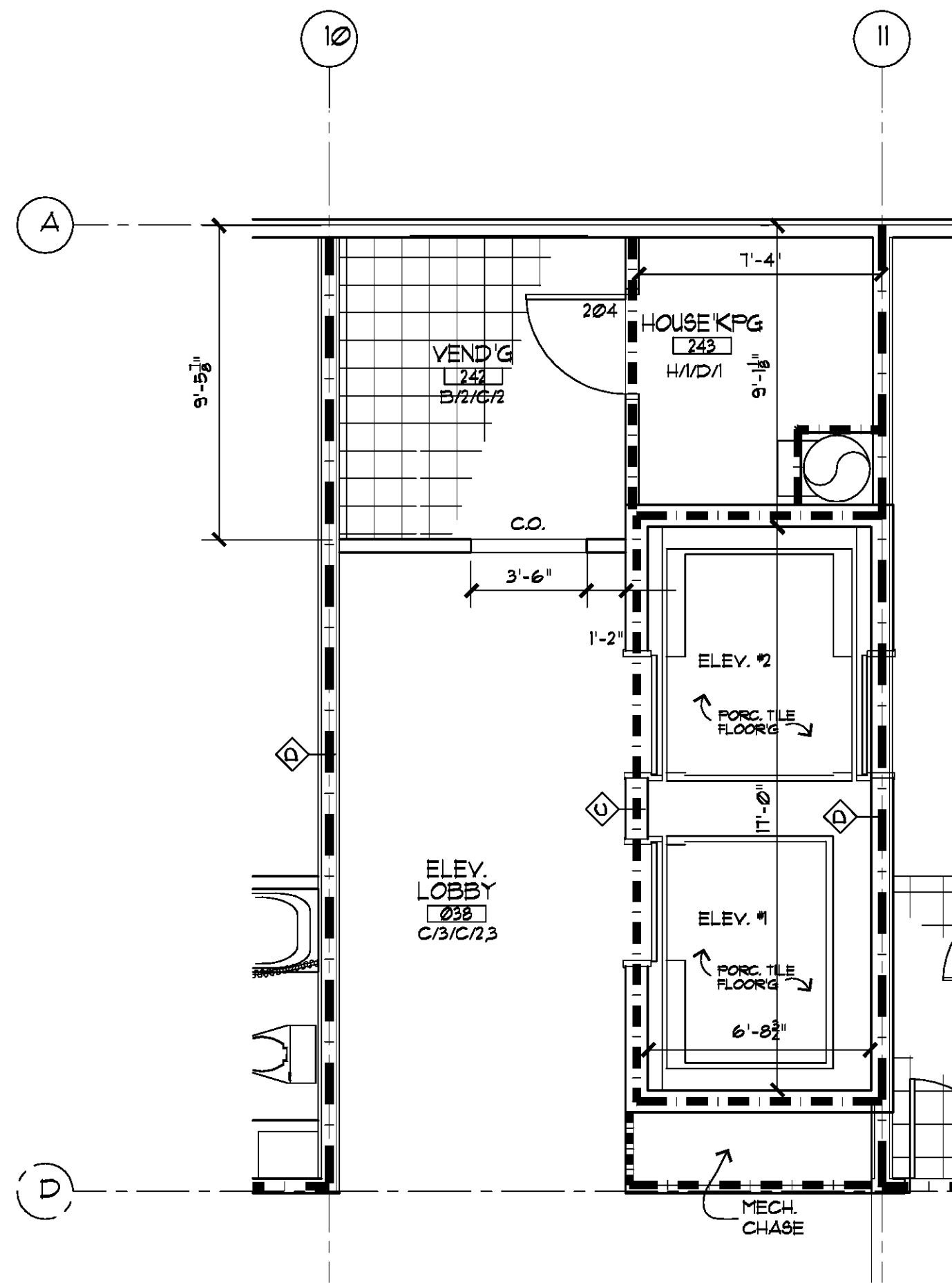

**2 PLAN @ ELEV. LOBBY (2nd/3rd flr.)**  
 1/4" = 1'-0"  
 AX-X-X



**Richard Molenaar**

ARCHITECT

**FINISH SCHEDULE**

100 Room Number

Room Name Room Name

A/V/V/ Ceiling Finish

Wall Finish

Base Finish

Floor Finish

**Floors**

- A. Thin Set Decorative Porcelain Tile 20"x20"  
Owner Furn. Owner Installed (O.F.O.I.)
- B. Thin Set Decorative Porcelain Tile  
Owner Furn. Owner Installed (O.F.O.I.)
- C. Carpet and Pad  
Owner Furn. Owner Installed (O.F.O.I.)
- D. Not Used
- E. Vinyl Composition Tile
- F. Ceramic Tile 8"x8" or 12"x12" (C.F.C.I.)
- G. Concrete, Sealed
- H. Painted Epoxy
- J. Abrasive Quarry Tile
- K. ECO surface rubber flooring, or equal, with a minimum 6 mm interlocking tiles in Bedrock Color (charcoal).

**Base**

- 1. 4" Vinyl
- 2. Ceramic Tile (O.F.O.I.)
- 3. 4" Carpet w/Top Binding Edge
- 4. Not Used
- 5. Match Flooring
- 6. Wood Base
- 7. Quarry Tile
- 8. None Required (O.F.O.I.)
- 9. 6" Carpet w/Top Binding Edge
- 10. 6" Charcoal-colored millwork by Johnsonite or equal.

**Walls**

- A. Painted Gyp. Bd. (Eggshell Oil Base Enamel)
- B. Ceramic Tile
- C. Vinyl Wallcovering
- D. Painted Gyp. Bd. (Semi-gloss Oil Base Enamel)
- E. Painted Concrete Masonry Units (Epoxy Paint)
- F. Not Used
- G. Textured -acrylic based splatter knock-down finish to meet franchisor and/or Owner specifications.

**Ceilings**

- 1. Textured -acrylic based splatter knock-down finish to meet franchisor and/or Owner specifications.
- 2. New Ceiling Panel System Identical to Armstrong #551 Chamfered Cirrus Pattern, 24"x24"x3/4" Regular Lay-In for Suprafine 9/16" Exposed Tee Grid, Panel 4 Grid Colour Selected By Interior Designer From Standard Colour Selections.
- 3. Painted Gyp. Bd. (Smooth Finish) Colour Selected By Interior Designer, Oil Base Enamel
- 4. New Ceiling Panel System Identical to Armstrong #605 Ceramaguard Nonperforated Square Lay-In, Med. Texture 24"x24"x3/8" for Prelude 15/16" Exposed Tee Grid, Panel 4 Grid Colour Selected By Owner From Standard Colour Selections.
- 5. New Ceiling Panel System Identical to Armstrong #756 Med. Fluted Square Lay-In, Med. Texture 24"x24"x3/8" for Prelude 15/16" Exposed Tee Grid, Panel 4 Grid Colour Selected By Owner From Standard Colour Selections.

PROJECT NAME:

**Hampton Inn**  
 Main Street  
 West Monroe, Louisiana

SHEET TITLE:

**Enlarged Plans**

PROJECT NO.

09017

LATEST REVISION:



DRAWN BY:

CJ

CHECKED BY:

RM

SHEET NUMBER:

DATE:

9/13/10

**A304**

