

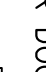

GENERAL NOTES

1. REFER TO SHEET A18 FOR BATHROOM ACCESSORIES SCHEDULE & MOUNTING LOCATION REQUIREMENTS (INTERIOR ELEVATIONS)
2. SYMBOL  INDICATES DOOR TYPE. REFER TO SHEET A9 FOR DOOR SCHEDULE INFORMATION.
3. SYMBOL  INDICATES WINDOW TYPE. REFER TO SHEET A9 FOR WINDOW SCHEDULE INFORMATION.
4. PROVIDE WOOD BLOCKING OR OTHER SOLID BOARD PARTITION FOR ATTACHMENT OF ALL FIXTURES, FITTINGS, AND ACCESSORIES.
5. GRAB BARS MUST BE ABLE TO RESIST A PULL FORCE OF 350 LBS. EXERTED AT ANY POINT IN ANY DIRECTION.
6. SYMBOL  INDICATES TOILET ACCESSORIES. SEE SHEET A16 FOR ACCESSORIES SCHEDULE.
7. MIRROR ABOVE VANITY AND ACCESSIBLE SINKS IS TO BE SUPPORTED WITH A CONTINUOUS CHROME FULL WIDTH J-CHANNEL FASTENED TO WALL ABOVE BACKSPASH.
8. CLOTHES ROD ASSEMBLY TO HAVE SMALL DIAMETER HOOKS IN LEO OF "PUZZLE" TYPE HANGERS.
9. CULTURED MARBLE VANITY TOP TO HAVE GLOSS FINISH TO MATCH TUB SURROUND.
10. ALL ELEC. OUTLETS ARE TO BE PREFINISHED STD. IVORY COLOR.
11. WINDOW DESIGNATION [A] IS TYPICAL FOR 1st FLOOR GUEST ROOMS
12. WINDOW DESIGNATION [B] IS TYPICAL FOR 2nd & 3rd FLOORS
13. REFER TO DETAIL 5/A16 FOR SOLID SURFACE (COMPOSITE) WINDOW SILL REQUIREMENTS
14. ALL DIMENSIONS ARE TO THE FACE OF STUDS (U.N.O.)
15. REFER TO SHEET S2, S2A, S2B & S2C FOR SHEAR WALL LOCATIONS.
16. REFER TO SHEET A9 FOR FINISH LEGEND.
17. PROVIDE WOOD BLOCKING IN CEILING FOR DRAPERY RODS AT WINDOWS WHERE REQUIRED. PROVIDE WOOD BLOCKING BETWEEN STUDS FOR - REFER TO 9/A11
18. REFER TO SHEET A1, A2 & A2B FOR ROOM NUMBERS
19. REFER TO DETAIL 7A/A11 FOR MARBLE THRESHOLD REQUIREMENTS
20. REFER TO SHEET A16 FOR TYPICAL GUEST ROOM & BATHROOM INTERIOR ELEVATIONS
21.  SYMBOL INDICATES WALL TYPE
22.  - SEE SHEET A10 FOR DETAILED DESCRIPTION

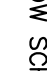
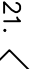

NOTE: IRON/ BOARD ORGANIZER SHALL BE SUPPLIED BY OWNER & INSTALLED BY CONTRACTOR

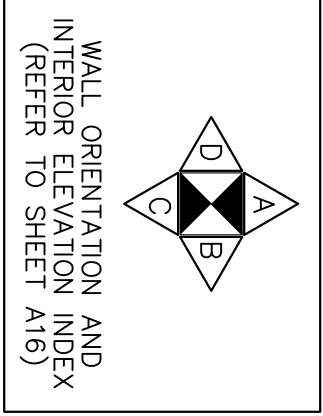
THESE DRAWINGS, DESIGNS, SKETCHES, IDEAS & ARRANGEMENTS ARE THE SOLE & EXCLUSIVE PROPERTY OF LEE GAGE & ASSOCIATES, AND WERE CREATED AND DEVELOPED BY AND FOR THE ARCHITECT'S EXCLUSIVE USE ON AND IN CONJUNCTION WITH THE ARCHITECT'S WORK. NOTHING CONTAINED OR REPRESENTED ON THESE DOCUMENTS SHALL BE USED BY OR DISCLOSED TO ANY PERSON, FIRM OR CORPORATION FOR ANY PURPOSE, WITHOUT EXPRESSED WRITTEN CONSENT OF LEE GAGE & ASSOCIATES.

PROPOSED:  
HAMPTON INN  
CORPORATE DRIVE  
SOUTH SAN FRANCISCO, CA.

by \_\_\_\_\_ date \_\_\_\_\_

drawn \_\_\_\_\_

checked \_\_\_\_\_

revised \_\_\_\_\_

revised \_\_\_\_\_

project no. \_\_\_\_\_

A5

sheet SET NO.

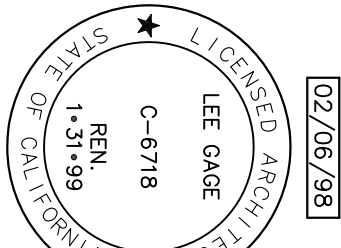

C:\SDSKPROJ\SouthSFO\DWG\SFO-A5.DWG

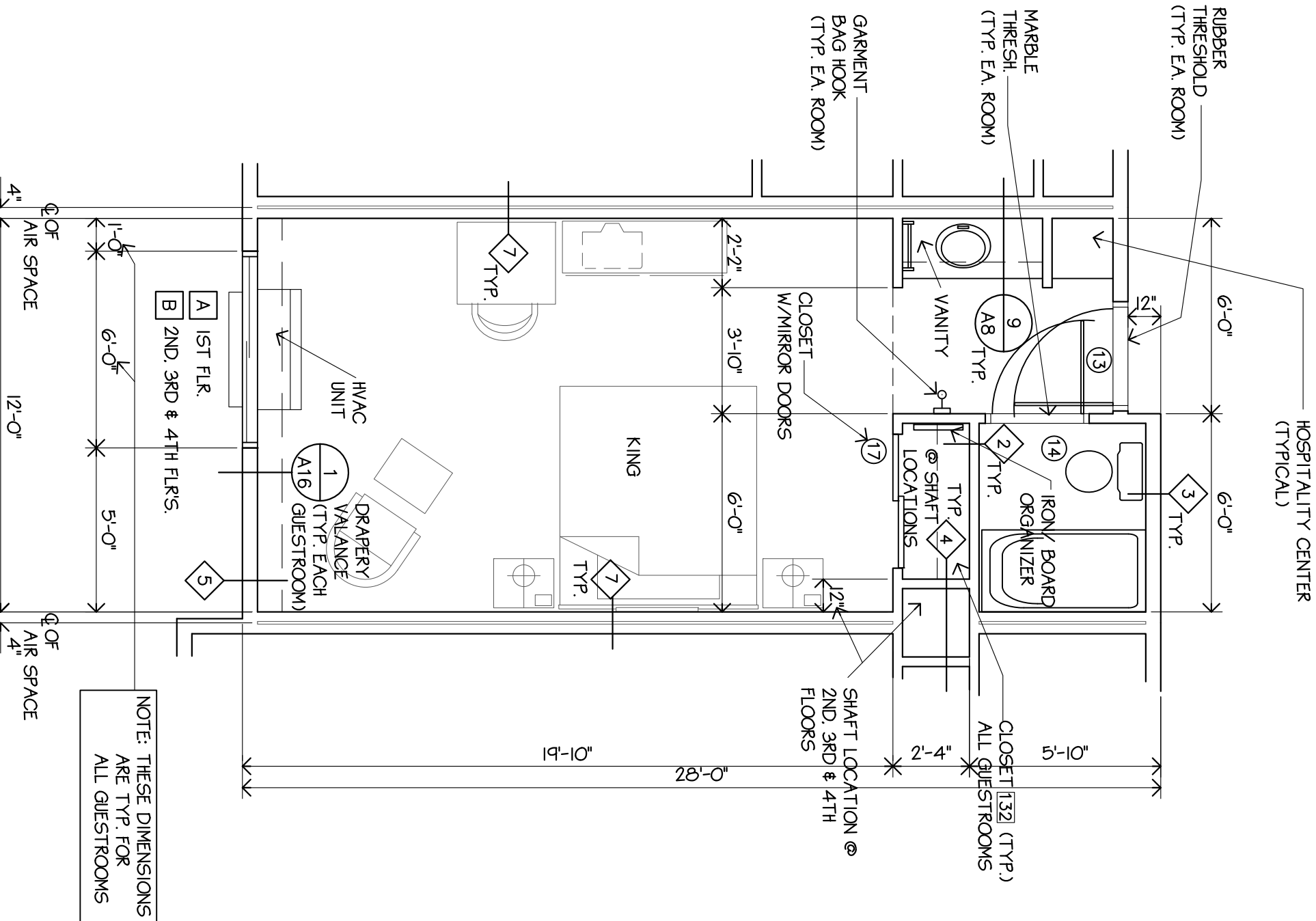

1 SINGLE KING (SK)  
AS SCALE: 1/4"=1'-0"  
29 THUS

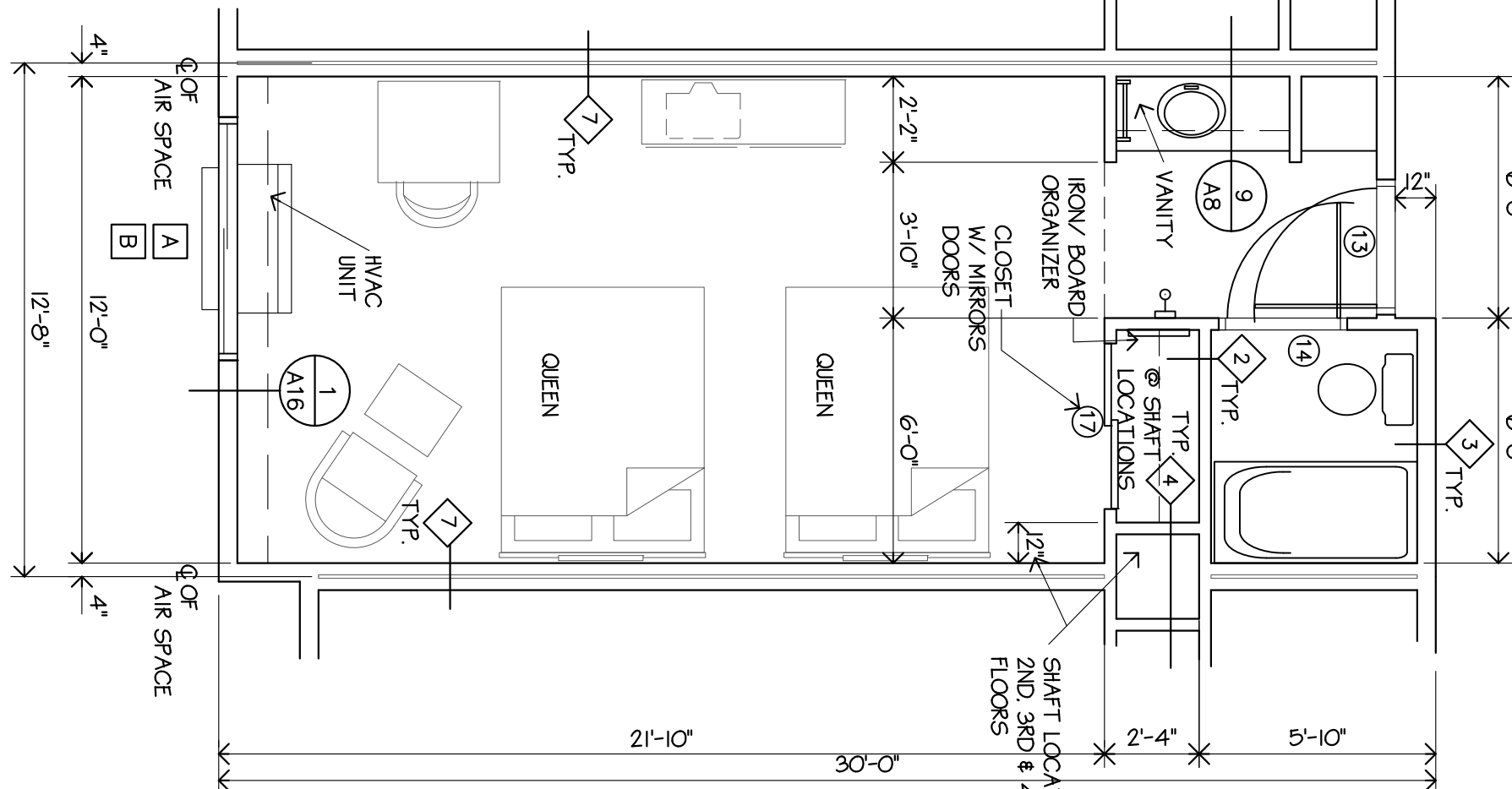

2 DOUBLE QUEEN (DQ)  
AS SCALE: 1/4"=1'-0"  
46 THUS

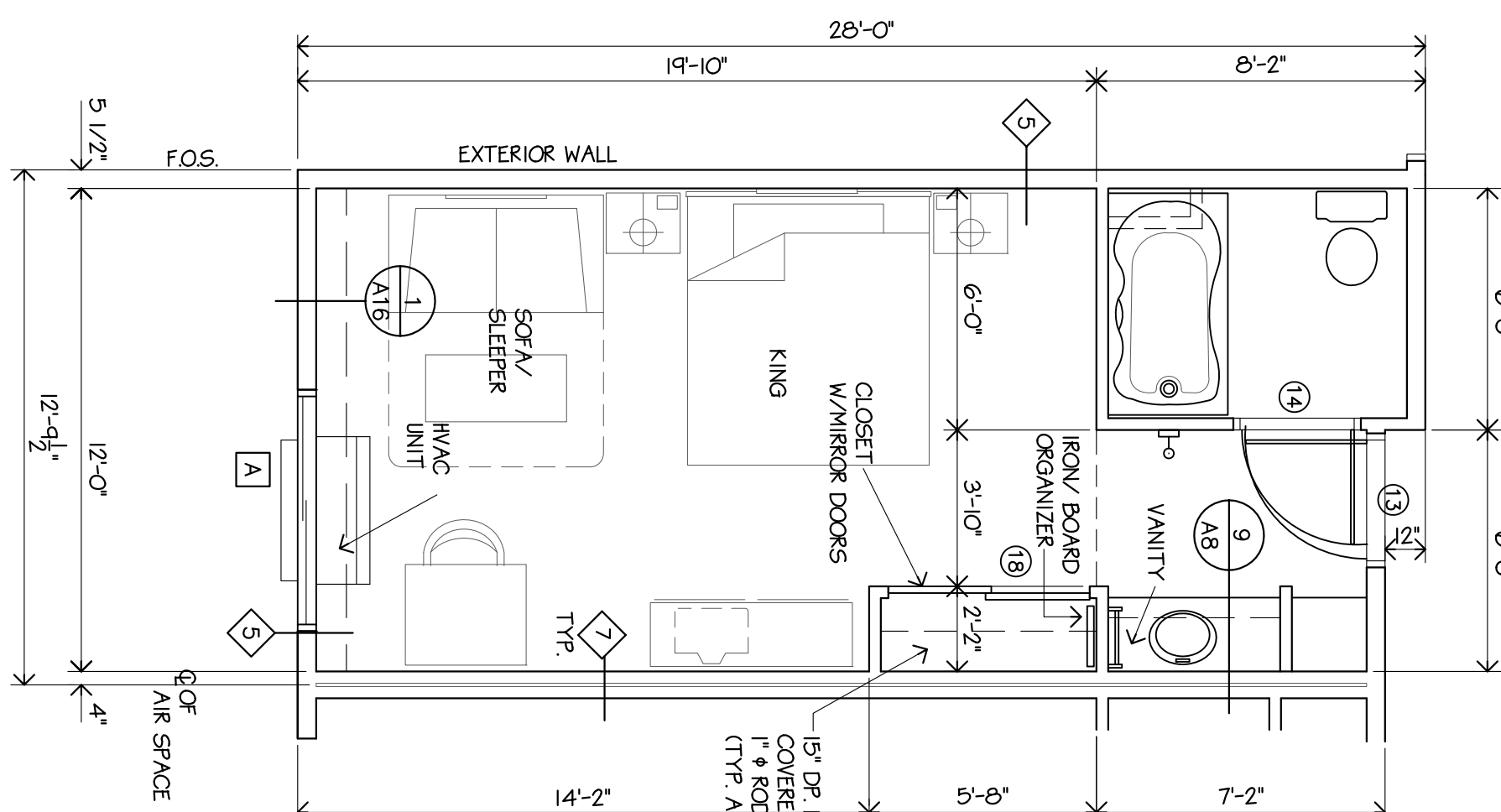

3 JACUZZI SUITE (JS)  
AS SCALE: 1/4"=1'-0"  
1 THUS

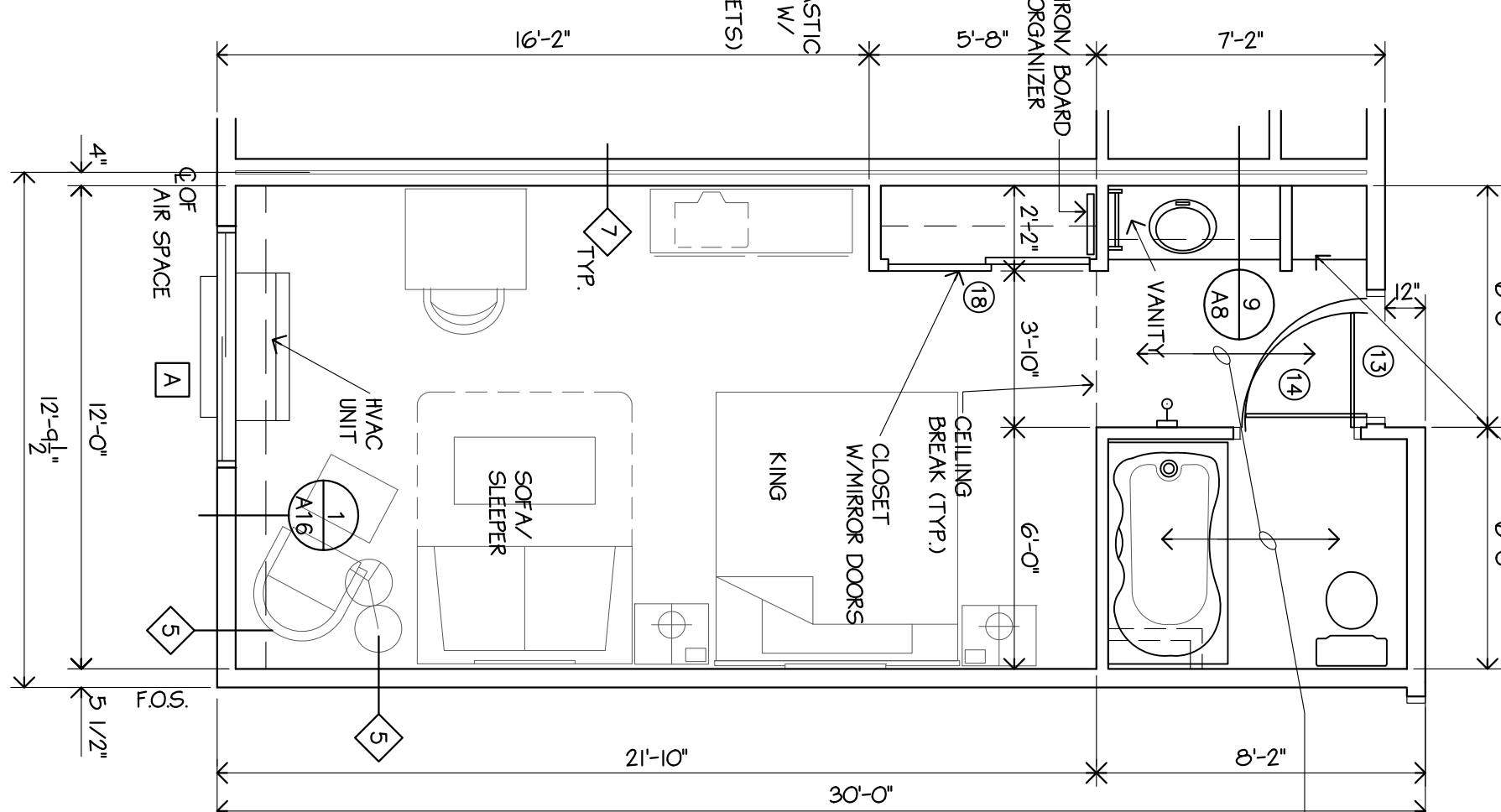

4 JACUZZI SUITE 2 (JS2)  
AS SCALE: 1/4"=1'-0"  
1 THUS

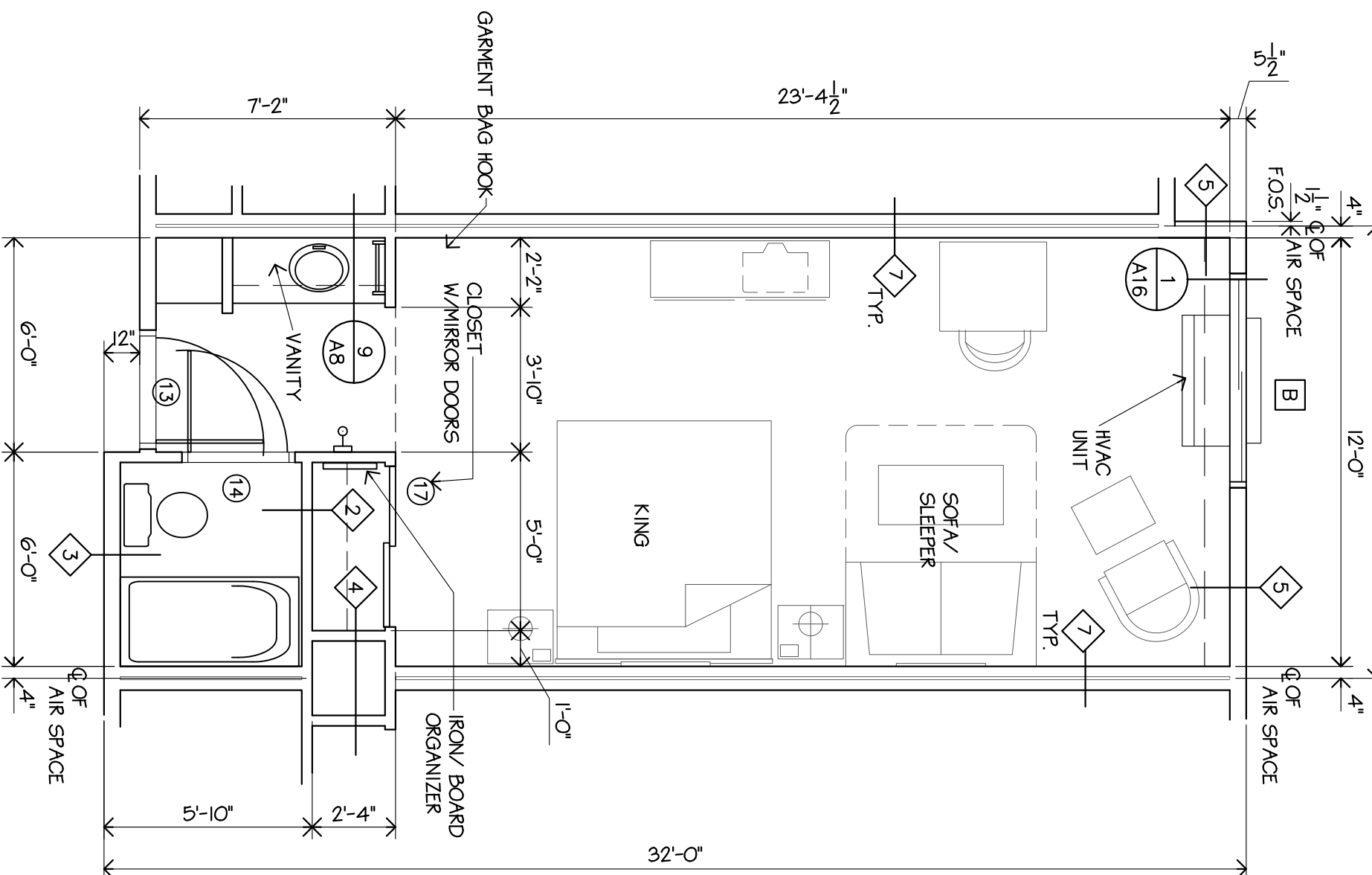

5 SUITE (ST)  
AS SCALE: 1/4"=1'-0"  
12 THUS

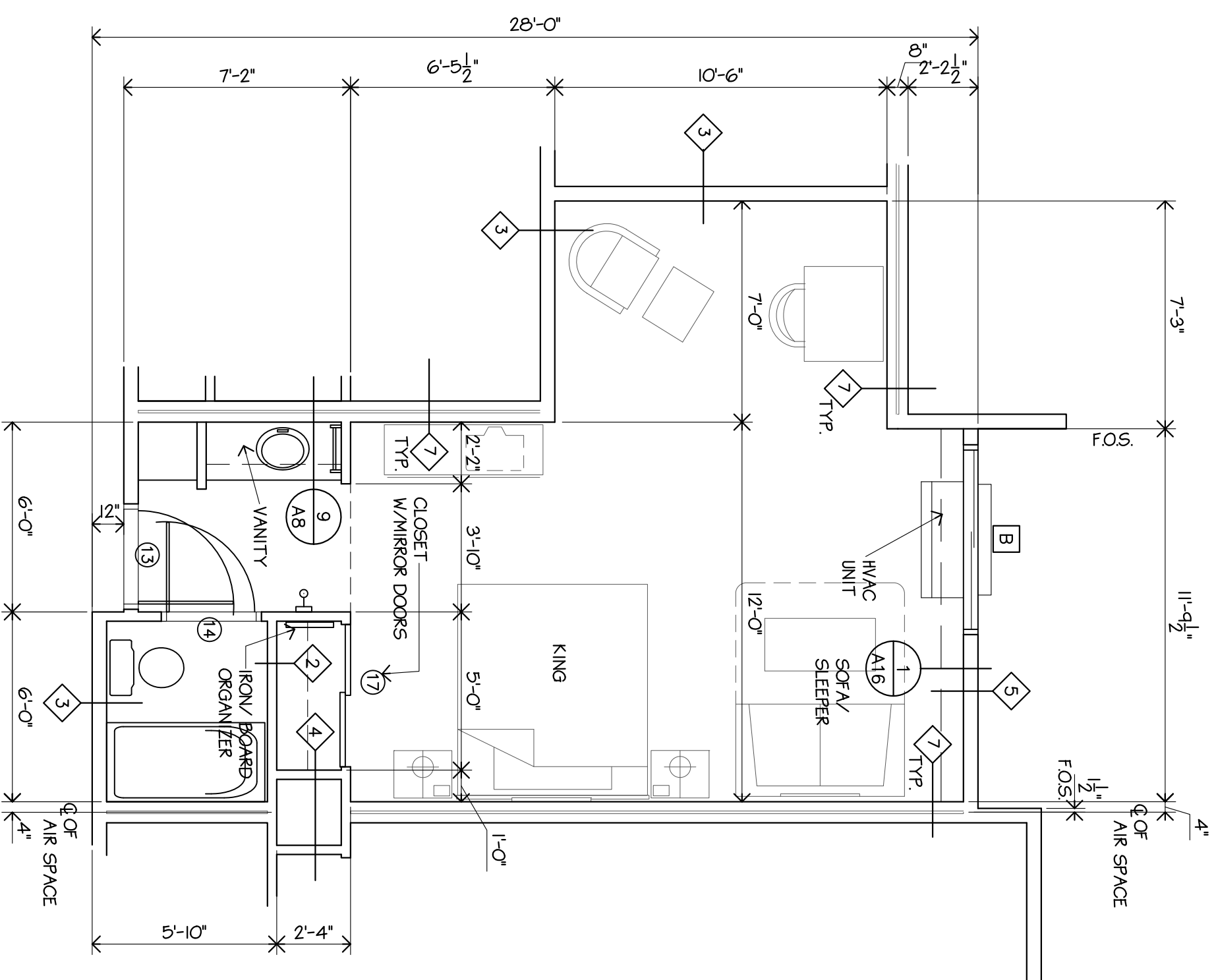

6 SUITE 2 (ST2)  
AS SCALE: 1/4"=1'-0"  
3 THUS

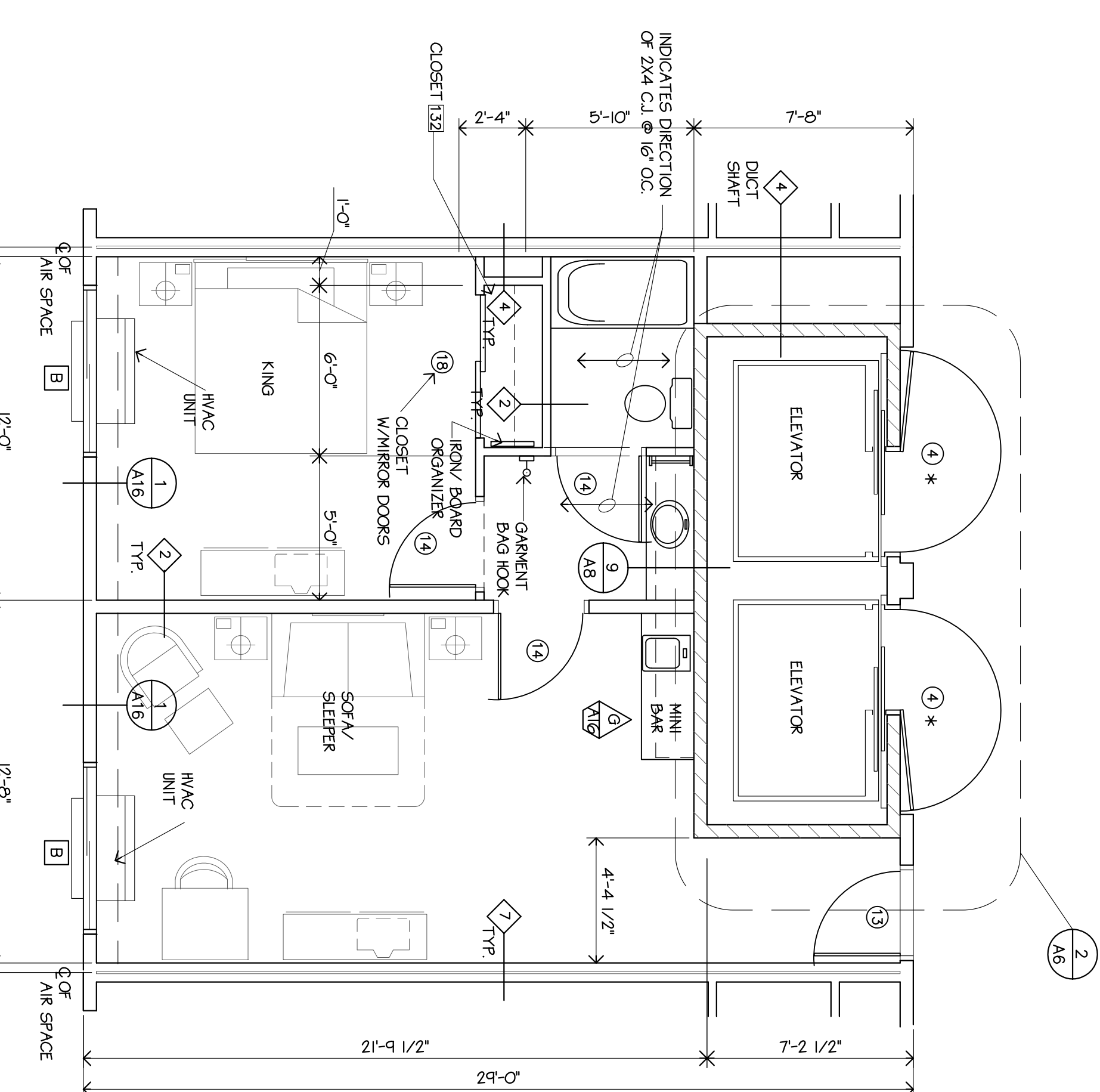

7 PRESIDENTIAL SUITE (PS)  
AS SCALE: 1/4"=1'-0"  
3 THUS