



HOLIDAY INN EXPRESS & SUITES

ABBREVIATIONS

ADJ.	ADJACENT	MAX.	MAXIMUM
A.F.F.	ABOVE FINISH FLOOR	MECH.	PLUMBING
ALT.	ALTERNATE	MIN. or MN.	MINIMUM
ALUM.	ALUMINUM	MISC.	MISCELLANEOUS
APPROX.	APPROXIMATE	MNT.	MOUNT OR MOUNTED
ARCH.	ARCHITECT	MTL.	METAL
BD.	BOARD	N.I.C.	NOT IN CONTRACT
BLDG.	BUILDING	NO.	NUMBER
C.A.	CLEAR ANODIZED	NOM.	NOMINAL
CEM.	CEMENT	N.S.F.S.	NEAR SIDE AND FAR SIDE
CER.	CERAMIC	N.T.S.	NOT TO SCALE
C.G.	CORNER GUARD	O.C.	ON CENTER
C.J.	CONTROL JOINT	OD.	OUTSIDE DIAMETER
CLG.	CEILING	O.F.C.I.	OWNER FURNISHED CONTRACTOR INSTALLED
C.M.U.	CONCRETE MASONRY UNIT	OPP.	OPPOSITE
COL.	COLUMN	O.R.D.	OVERFLOW ROOF DRAIN
CONC.	CONCRETE	P.L. or PLAM	PLASTIC LAMINATE
CONT.	CONTINUOUS	PLYWD.	PLYWOOD
CORR.	CORRIDOR	PNT	PAINT
C.T.	CERAMIC TILE	P.S.B.	PENCIL SHARPENER BOARD
DET.	DETAIL	P.T.	PRESSURE TREATED
DIA.	DIAMETER	Q.T.	QUARRY TILE
DN.	DOWN	RAD.	RADIUS
D.S.	DOWNSPOUT	R.D.L.	ROOF DRAIN LEADER
DWG.	DRAWING	REINF.	REINFORCEMENT
E.A.	EACH	REQD.	REQUIRED
E.I.F.S.	EXTERIOR INSULATION AND FINISH SYSTEM	RES.	RESILIENT
E.J.	EXPANSION JOINT	RM.	ROOM
ELEC.	ELECTRICITY	R.D.	ROUGH OPENING
ELEV.	ELEVATOR	R.O.	ROUGH OPENING
E.O.S.	EDGE OF SLAB	S.C.	SOLID CORE
EQ.	EQUAL	SCWD.	SOLID CORE WOOD
EXIST.	EXISTING	S.F.	SQUARE FEET
EXP.	EXPANSION	SHT.	SHEET
EXT.	EXTERIOR	SIM.	SIMILAR
F.D.	FLOOR DRAIN	ST.	STAIN
F.E.	FIRE EXTINGUISHER	STD.	STANDARD
F.E.C.	FIRE EXTINGUISHER CABINET	STG.	STAGGER TOP AND BOTTOM
F.H.C.	FIRE HOSE CABINET	STL.	STEEL
FIN.	FINISH	STOR.	STORAGE
FL.	FLOOR	STRUCT.	STRUCTURE
F.O.B.	FACE OF BRICK	SUSP.	SUSPENDED
F.O.S.	FACE OF STUD	SYNTH.	SYNTHETIC
F.R.P.	FIBER REINFORCED PANEL	T.O.S.	TOP OF STEEL
F.R.T.	FIRE RETARDANT TREATED	TEL.	TELEPHONE
F.S.	FLOOR SINK	TEMP.	TEMPERED
GALV.	GALVANIZED	THK.	THICKNESS
GL.	GLASS	TYP.	TYPICAL
GWB.	GYP SUM WALL BOARD	U.O.N. or U.N.O	UNLESS OTHERWISE NOTED
GYP.	GYP SUM	UTIL.	UTILITY
HGT.	HEIGHT	V.C.T.	VINYL COMPOSITION TILE
HORIZ.	HORIZONTAL	VERT.	VERTICAL
HR.	HOUR	V.W.C.	VINYL WALL COVERING
ID.	INSIDE DIAMETER	WC.	WATER CLOSET
INSUL.	INSULATION	WD.	WOOD
JST.	JOIST	WP.	WATER PROOFING
JT.	JOINT	WT.	WEIGHT
LAM.	LAMINATE	W.W.F.	WELDED WIRE FABRIC
M.O.	MASONRY OPENING	W/	WITH
MACH.	MACHINE	W/O	WITHOUT
		XTG.	EXISTING

FLOOR	AREA (SQUARE FEET)
First Floor:	14, 776
Second Floor:	14, 497
Third Floor:	14, 497
Fourth Floor:	14, 497
GRAND TOTAL:	58, 267

TOTAL NUMBER OF ROOMS: 95
TOTAL PARKING: 101 (INCLUDING 4 ADA)
TOTAL NUMBER OF FLOORS: FOUR
OCCUPANCY CLASSIFICATION: R1
TYPE OF CONSTRUCTION: IV-B: WOOD-FRAMED WITH
WOOD FLOORS, JOISTS (FULLY SPRINKLERED)
MAXIMUM HEIGHT OF BUILDING: 52 FEET

ROOM LEGEND															
GUESTROOM TYPE	KING	DOUBLE QUEEN	KING WIDE	KING X-WIDE	KING SUITE	DOUBLE QUEEN SUITE	ACCESSIBLE ROLL-IN X-WIDE KING	ACCESSIBLE X-WIDE KING	ACCESSIBLE DOUBLE QUEEN	ACCESSIBLE KING SUITE	ACCESSIBLE DOUBLE QUEEN SUITE	HEARING IMPAIRED KING	HEARING IMP. DOUBLE QUEEN	HEARING IMP. KING SUITE	HEAR. IMP. DOUBLE QUEEN STE
FLOOR															
FIRST FLOOR	3	0	0	0	0	0	1	0	0	0	0	1	0	0	5
SECOND FLOOR	11	9	1	0	3	1	0	1	0	1	0	1	1	0	30
THIRD FLOOR	12	9	0	1	3	2	0	0	0	0	1	1	1	0	30
FOURTH FLOOR	13	8	0	1	2	2	0	0	1	0	0	1	1	1	30
TOTAL	39	26	1	2	8	5	1	1	1	1	1	4	3	1	95
RATIO %	41.1	27.4	1	2.1	8.4	5.3	1	1	1	1	1	4.2	3.1	1	100

ACCESSIBLE ROLLIN KING: 1
ACCESSIBLE ROOMS: 4
TOTAL NUMBER OF ACCESSIBLE ROOMS: 5

TOTAL HEARING IMPAIRED ROOMS: 9

MATERIAL LEGEND

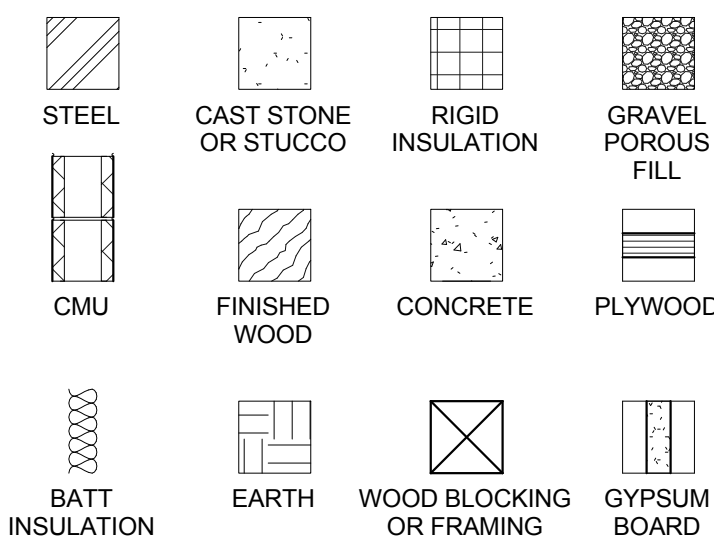

REQUIREMENT BY CITY OF SOUTHAVEN:

1. GENERAL CONTRACTOR TO PROVIDE THIRD-PARTY INSPECTIONS FOR THE FOUNDATION, FRAMING AND FIRE CAULKING FOR THE PROJECT. RESULTS OF INSPECTIONS NEED TO BE SUBMITTED TO ARCHITECT AND CITY OF SOUTHAVEN FOR APPROVAL.

Title Sheets	
Sheet #	Sheet Name
T000	Cover
T001	Code Information
T002	UL Details
T003	UL Details
T004	UL Details
T005	UL Details
T006	ADA Details
T007	ADA Details
T008	Mounting Heights

Architectural Sheets	
Sheet #	Sheet Name

A001	Site Plan
A101	First Floor Plan
A102	Second Floor Plan
A103	Third Floor Plan
A104	Fourth Floor Plan
A105	Roof Plan
A201	First Floor RCP
A202	Second Floor RCP
A203	Third Floor RCP
A204	Fourth Floor RCP
A301	Elevations
A302	Elevations
A401	Sections
A402	Sections
A403	Sections
A404	Wall Types
A405	Roof Details
A406	Canopy Details
A407	Canopy Details
A501	Room Layouts
A502	Room Layouts
A503	King & King Suite
A504	Accessible King Suite & King X wide
A505	Accessible X wide King and Double Queen
A506	Double Queen Suite and Accessible Double Queen
A520	Stair Details
A521	Administrative Area Layout
A522	Pool, Restrooms and Elevator
A601	Interior Elevations
A602	Interior Elevations
A603	Casework Types and Details
A604	Casework Details
A605	Casework Details
A606	Casework Details
A607	Casework Details
A701	Room Schedule
A702	Door & Window Schedule
A801	Firewall Plan 1st Floor
A802	Firewall Plan 2nd Floor
A803	Firewall Plan 3rd Floor
A804	Firewall Plan 4th Floor

Civil Sheets	
Sheet #	Sheet Name
C1.0	General Notes and Details
C2.0	Site Plan
C3.0	Utility Layout
C3.1	Grading and Drainage Plan
C3.2	Erosion Control Plan
C4.0	Water, Sewer & Storm Drain Details
C4.1	Construction Details

Structural Sheets	
Sheet #	Sheet Name
S001	General Notes
S002	General Notes
S003	Special Inspections
S101	Foundation and Floor Slab Plan
S201	2nd Floor Framing Plan
S202	3rd and 4th Floor Framing Plan
S203	Roof Framing Plan
S301	Foundation, Section and Details
S302	Foundation, Section and Details
S401	Floor Framing Section & Details
S402	Floor Framing Section & Details
S501	Roof Framing Section & Details
S502	Roof Framing Section & Details
S601	Simpson ATS Details
S602	Simpson ATS Elevations

Mechanical Sheets	
Sheet #	Sheet Name
M001	Mechanical Legend & Schedules
M002	Mechanical Notes and Details
M003	Mechanical Details
M101	Mechanical 1st Floor Plan
M102	Mechanical 2nd Floor Plan
M103	Mechanical 3rd Floor Plan
M104	Mechanical 4th Floor Plan
M201	Mechanical Roof Plan
M301	Mechanical Enlarged Guestroom Plans
M302	Mechanical Enlarged Guestroom Plans

Plumbing Sheets	
Sheet #	Sheet Name
P001	Plumbing Notes and Legend
P002	Plumbing Schedule
P003	Plumbing Details
P004	Plumbing Details
P100	Plumbing First Floor Plan Sanitary and Storm
P101	Plumbing First Floor Plan Water and Gas
P102	Plumbing Second Floor Plan
P103	Plumbing Third Floor Plan
P104	Plumbing Fourth Floor Plan
P105	Plumbing Roof Plan
P201	Plumbing Enlarged Guest Room Plans Sanitary
P202	Plumbing Enlarged Guest Room Plans Sanitary
P203	Plumbing Enlarged Guest Room Plans Water
P204	Plumbing Enlarged Guest Room Plans Water
P205	Plumbing Enlarged Plans Sanitary
P206	Plumbing Enlarged Plans Water and Gas
P301	Plumbing Riser Diagrams Sanitary
P302	Plumbing Riser Diagrams Sanitary
P303	Plumbing Riser Diagrams Sanitary
P304	Plumbing Riser Diagrams Water

Electrical Sheets	
Sheet #	Sheet Name
E001	Electrical Specifications
E002	Electrical Schedules
E003	Electrical Details
E004	Electrical Details
E100	Site Plan-Electrical
E100A	Site Plan-Photometrics
E101	1st Floor Plan-Lighting
E102	2nd Floor Plan-Lighting
E103	3rd Floor Plan-Lighting
E104	4th Floor Plan-Lighting
E201	1st Floor Plan-Power
E202	2nd Floor Plan-Power
E203	3rd Floor Plan-Power
E204	4th Floor Plan-Power
E205	Roof Plan-Power
E301	Enlarged Public Area Plan-Power
E302	Enlarged Public Area Plan-Power
E303	Enlarged Public Area Plan-Power
E304	Enlarged Guest Room Plans
E305	Enlarged Guest Room Plans
E401	Telephone & Fire Alarm Riser Diagrams
E402	Power Riser Diagrams
E501	Electrical Panel Schedules
E502	Electrical Panel Schedules
E503	Electrical Panel Schedules
E504	Electrical Panel Schedules
E505	Electrical Panel Schedules

REVISIONS		
No.	Date	Description

Information contained on this drawing and in all digital files associated is authorized for use on the project named herein only and is the property of MISHRA ARCHITECTURE PLLC and may not be reproduced in any manner without express written or verbal permission from authorized individuals. Original drawing is 24"x36" and scales are as indicated. ©2013 MISHRA ARCHITECTURE PLLC

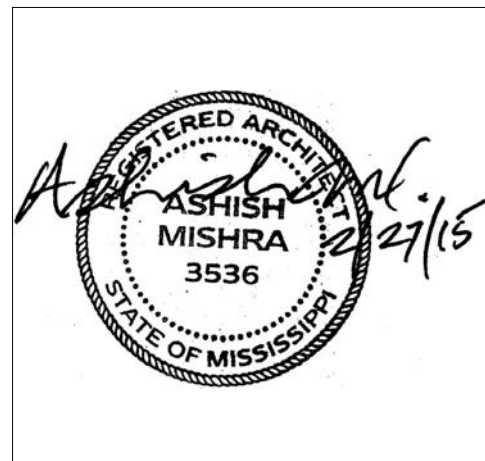

KEY PLAN

Shiva Southaven Inc.

Holiday Inn Express & Suites

Lot 16 (Rev Lot 3) Southcrest Pkwy.
Southcrest Subdivision
Southaven, MS 38671

Drawing Title
Cover

Phase
Construction Documents

Project No.	14-081	Sheet No.	T000
Prepared by	Author		
Checked by	Checker		
Date	Feb. 27, 2015		

Review