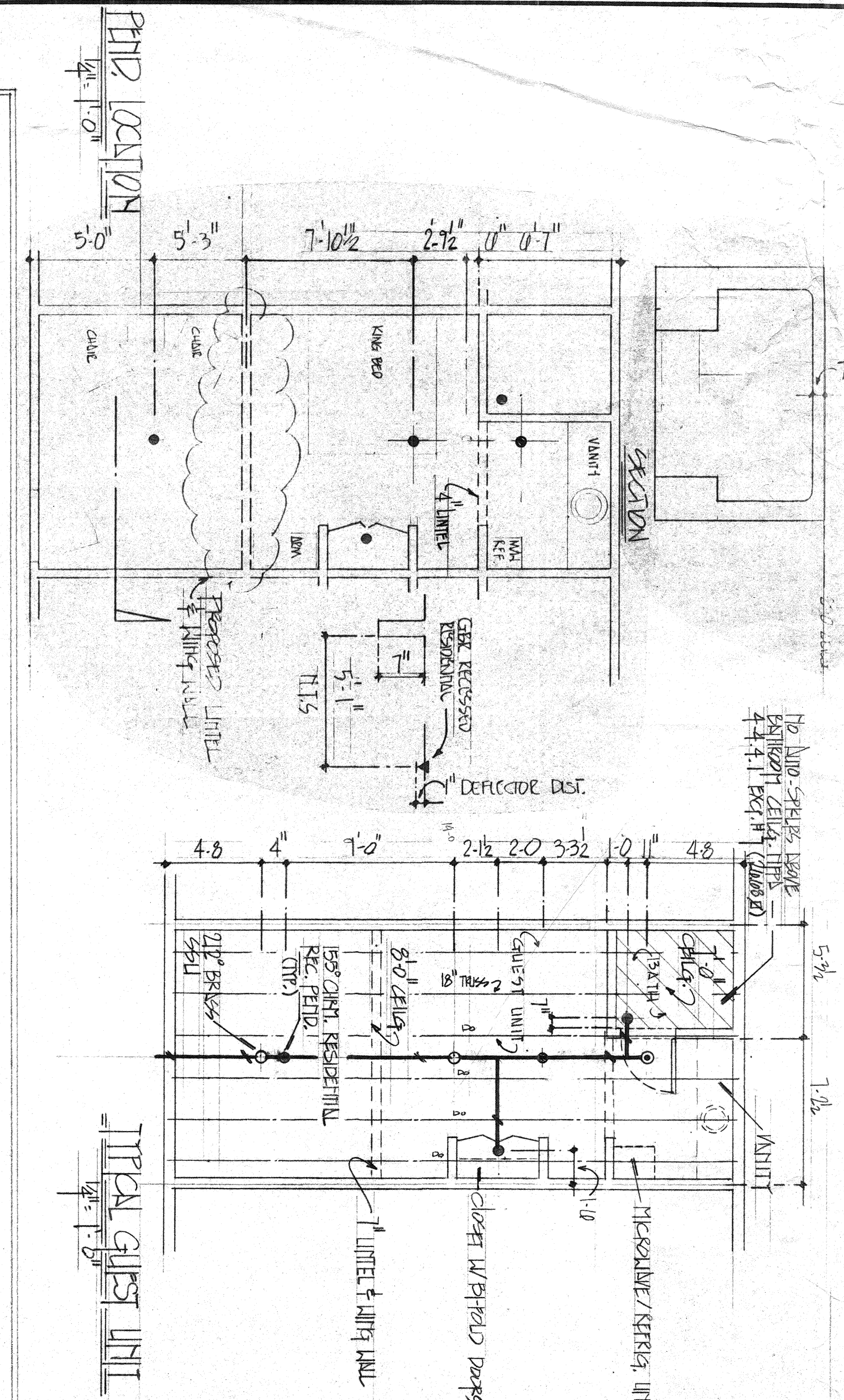
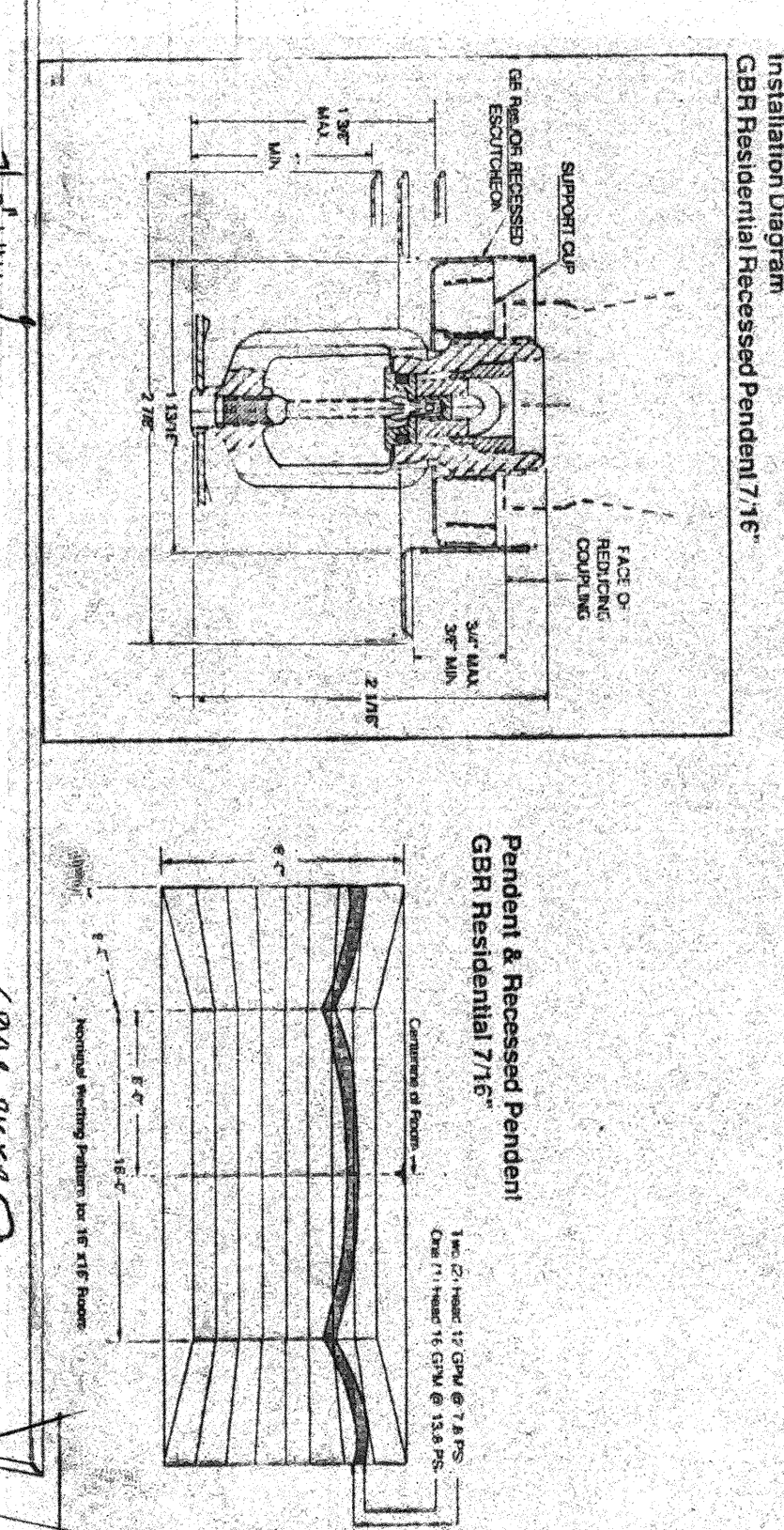
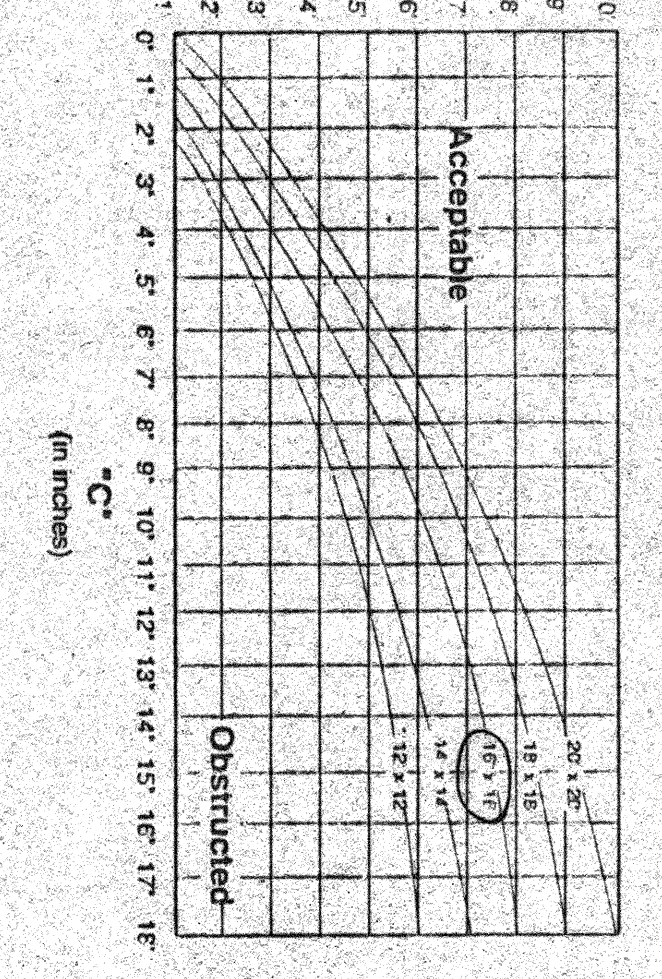

Figure 11
Beam Obstructions for Pendant Sprinklers

Obstructions to spraying patterns can be beams, light fixtures, ceiling fixtures and ornamental decorations. The key to using Figure 11 is to verify the distance of the obstructions from the bottom of the obstruction "C" and the distance away from the edge of the obstruction "D". It is obtained per Figure 11 Graph.



HANGER NUMBERS AND DESCRIPTIONS		SYMBOLS AND ABBREVIATIONS		SPRINKLERS		CONTRACT RESPONSIBILITIES	
#1	Unhook	○	NOTE: # FOR HYDRA-CALC.	QTY	SYMB	TYPE	FINISH
#2	Weld-on Hook	○	5' OF PIPE ABOVE FINISH FLOOR	SC	○	UPRIGHT ON SPRING	UNDERGROUND WATER MAINS
#3	Unhook U-Bolt	○	5' OF PIPE ABOVE FINISH FLOOR	NTS	○	UPRIGHT ON SPRING	EXCAVATION
#4	Unhook U-Bolt	○	5' OF PIPE ABOVE FINISH FLOOR	NTS	○	UPRIGHT ON SPRING	BACKFILL
#5	Unhook U-Bolt	○	5' OF PIPE ABOVE FINISH FLOOR	NTS	○	UPRIGHT ON SPRING	PAINTING
#6	Unhook U-Bolt	○	5' OF PIPE ABOVE FINISH FLOOR	NTS	○	UPRIGHT ON SPRING	PAINTING
#7	Unhook U-Bolt	○	5' OF PIPE ABOVE FINISH FLOOR	NTS	○	UPRIGHT ON SPRING	PAINTING
#8	Unhook U-Bolt	○	5' OF PIPE ABOVE FINISH FLOOR	NTS	○	UPRIGHT ON SPRING	PAINTING
#9	Unhook U-Bolt	○	5' OF PIPE ABOVE FINISH FLOOR	NTS	○	UPRIGHT ON SPRING	PAINTING
#10	Unhook U-Bolt	○	5' OF PIPE ABOVE FINISH FLOOR	NTS	○	UPRIGHT ON SPRING	PAINTING
#11	Unhook U-Bolt	○	5' OF PIPE ABOVE FINISH FLOOR	NTS	○	UPRIGHT ON SPRING	PAINTING
#12	Unhook U-Bolt	○	5' OF PIPE ABOVE FINISH FLOOR	NTS	○	UPRIGHT ON SPRING	PAINTING

AS-BUILT

REDWOOD CITY TOTAL
1834 FLORENCE REAL
REDWOOD CITY, CA 94063

THIS PLAN PREPARED BY THE OFFICE FOR:
NEW LEX #22896
CALL LEX #48874

1487 GREG ST
SPOKES, WA 99431
(509) 359-0888

4555 Auburn Blvd, #21
Sacramento, CA 95841
(916) 485-0720

Systems-Tech

FAST CLAMP SWAY BRACE ATTACHMENT

FIG. 1000

Size Range: 1/2" to 1 1/2" max. bracing pipe.
Material: Carbon Steel.
Function: For bracing pipe against sway and seismic disturbance. The bracing pipe is attached to the structure using the Fast Clamp Sway Brace Attachment. The Fast Clamp Sway Brace Attachment is used in conjunction with the Fig. 1000 Test Clamp (or with a Fig. 1000 Test Clamp) and joined together with a steel pipe per NFPA 1000. The Fast Clamp Sway Brace Attachment is used to attach the bracing pipe to the structure at any angle. All steel construction estimates deficiencies associated with the use of the Fast Clamp Sway Brace Attachment. The Fast Clamp Sway Brace Attachment is used to attach the bracing pipe to the structure at any angle. All steel construction estimates deficiencies associated with the use of the Fast Clamp Sway Brace Attachment.

SWIVEL SWAY BRACE FITTING

FIG. 910

Size Range: 1/2" to 1 1/2" max. bracing pipe.
Material: Carbon Steel.
Function: For bracing pipe against sway and seismic disturbance. The bracing pipe is attached to the structure using the Swivel Sway Brace Fitting. The Swivel Sway Brace Fitting is used in conjunction with the Fig. 1000 Test Clamp (or with a Fig. 1000 Test Clamp) and joined together with a steel pipe per NFPA 1000. The Swivel Sway Brace Fitting is used to attach the bracing pipe to the structure at any angle. All steel construction estimates deficiencies associated with the use of the Swivel Sway Brace Fitting.

FAST CLAMP SWAY BRACE FITTING

FIG. 910

Size Range: 1/2" to 1 1/2" max. bracing pipe.
Material: Carbon Steel.
Function: For bracing pipe against sway and seismic disturbance. The bracing pipe is attached to the structure using the Fast Clamp Sway Brace Fitting. The Fast Clamp Sway Brace Fitting is used in conjunction with the Fig. 1000 Test Clamp (or with a Fig. 1000 Test Clamp) and joined together with a steel pipe per NFPA 1000. The Fast Clamp Sway Brace Fitting is used to attach the bracing pipe to the structure at any angle. All steel construction estimates deficiencies associated with the use of the Fast Clamp Sway Brace Fitting.

HOLIDAY EXPRESS, REDWOOD CITY