

* VAN ACCESSIBLE PARKING SPACES ARE PERMITTED TO BE 96" WIDE IF ADJACENT ACCESS AISLE IS 96" WIDE MINIMUM

NOTE: 2 ACCESSIBLE SPACES MAY SHARE AN ACCESS AISLE

NOTES:

1. PARKING SPACE IDENTIFICATION SIGN SHALL INCLUDE THE INTERNATIONAL SYMBOL OF ACCESSIBILITY THAT COMPLIES WITH THE 2010 ADA STANDARDS 703.7.2.1.
2. SIGNS IDENTIFYING VAN PARKING SPACES SHALL CONTAIN THE DESIGNATION "VAN ACCESSIBLE."
3. LOCATE SIGN SO AS NOT TO BE OBSCURED BY VEHICLE PARKED IN SPACE.
4. REFER TO STATE AND LOCAL CODES FOR ADDITIONAL REQUIREMENTS, INCLUDING FINE INFORMATION.

TOTAL NUMBER OF SPACES PROVIDED IN PARKING FACILITY	MINIMUM NUMBER OF REQUIRED ACCESSIBLE PARKING SPACES
1 TO 25	1
26 TO 50	2
51 TO 75	3
76 TO 100	4
101 TO 150	5
151 TO 200	6
201 TO 300	7
301 TO 400	8
401 TO 500	9
501 TO 1000	2% OF TOTAL
1001 AND OVER	20, PLUS 1 FOR EACH 100, OR FRACTION THEREOF, OVER 1000

NOTE: FOR EVERY 6 OR FRACTION OF SIX ACCESSIBLE PARKING SPACES PROVIDED, ONE SHALL BE A VAN ACCESSIBLE PARKING SPACE.

NOTES:

1. DIMENSIONS OF PARKING SPACES AND ACCESS AISLES ARE MEASURED FROM THE CENTERLINE OF MARKING (STRIPE).
2. PARKING SPACES FOR VANS, ACCESS AISLES, AND VEHICULAR ROUTES SERVING THEM SHALL HAVE A VERTICAL CLEARANCE OF 98" MINIMUM.
3. THE ACCESS AISLE SHALL ADJOIN AN ACCESSIBLE ROUTE THAT CONNECTS PARKING SPACES TO ACCESSIBLE ENTRANCES.
4. PARKING SPACES AND ACCESS AISLES SHALL BE DESIGNED SO THAT CARS AND VANS, WHEN PARKED, CANNOT OBSTRUCT THE REQUIRED CLEAR WIDTH OF ADJACENT ACCESSIBLE ROUTES.
5. REFER TO STATE AND LOCAL CODES FOR PAVEMENT MARKING REQUIREMENTS.

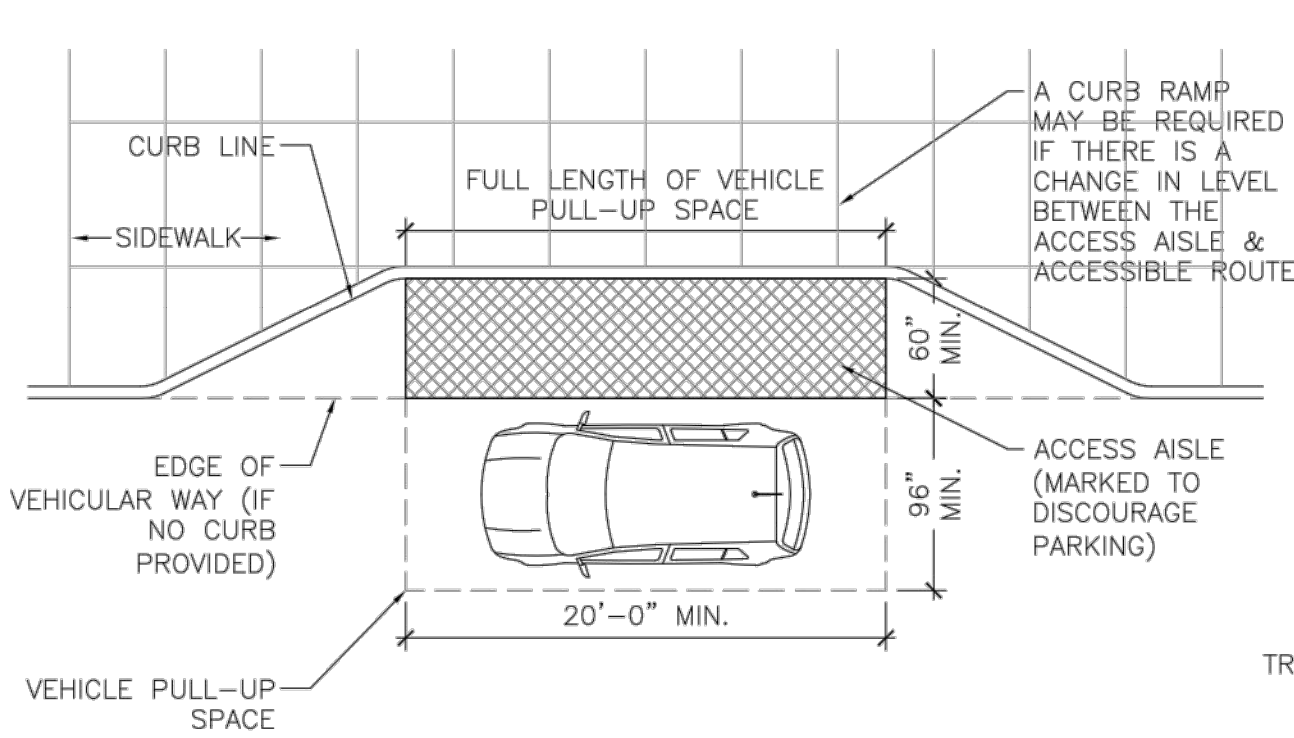

NOTES:

1. THE ACCESS AISLE SHALL ADJOIN AN ACCESSIBLE ROUTE AND MAY NOT OVERLAP THE VEHICULAR WAY.
2. IF THE ACCESSIBLE ROUTE (SIDEWALK) IS NOT LEVEL WITH THE ACCESS AISLE, AN ACCESSIBLE RAMP OR CURB RAMP MUST BE PROVIDED.
3. ACCESS AISLES SHALL BE AT THE SAME LEVEL AS THE VEHICLE PULL-UP SPACE THEY SERVE. CHANGES IN LEVEL ARE NOT PERMITTED.
4. THE SLOPE OF THE VEHICLE PULL-UP SPACES AND ACCESS AISLES SERVING THEM SHALL NOT EXCEED 2% IN ANY DIRECTION.
5. VEHICLE PULL-UP SPACES, ACCESS AISLES SERVING THEM, AND A VEHICULAR ROUTE FROM AN ENTRANCE TO THE PASSENGER LOADING ZONE, AND FROM THE PASSENGER LOADING ZONE TO A VEHICULAR EXIT SHALL HAVE A VERTICAL CLEARANCE OF 114" MINIMUM.
6. THE ACCESS AISLE MUST BE MARKED (I.E. A VARIATION IN THE SURFACE MATERIAL OR STRIPING) TO PREVENT CARS FROM PARKING IN THE AREA.

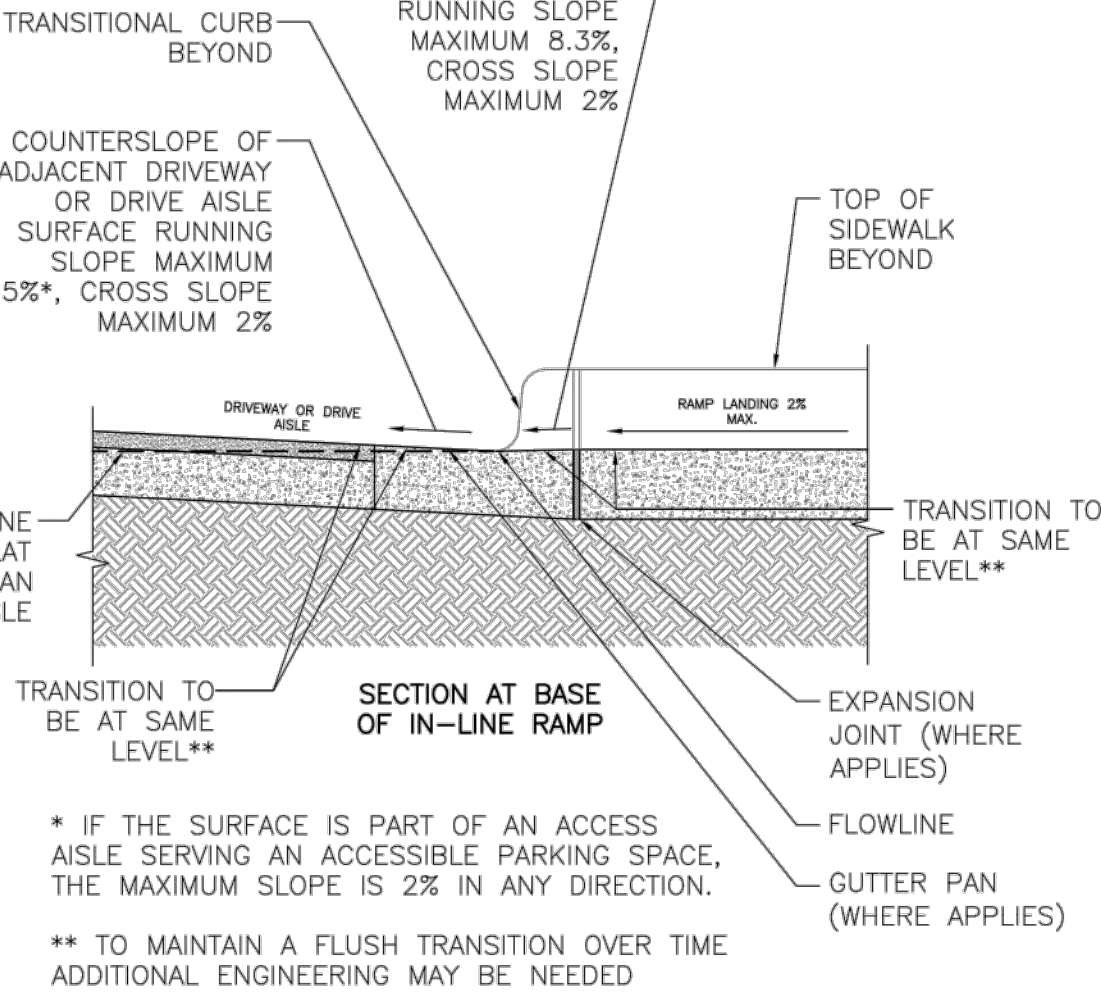
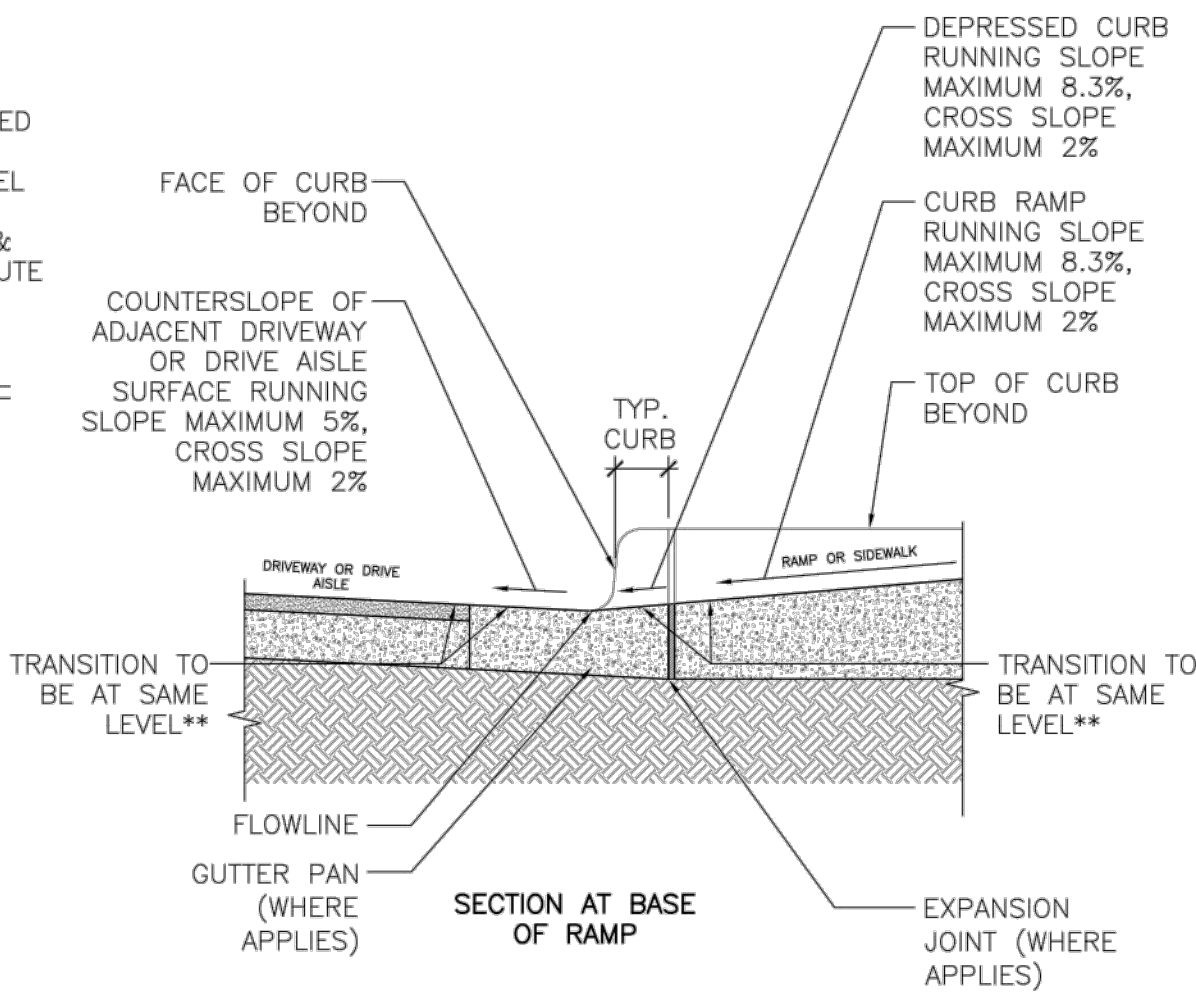

1 ACCESSIBLE PARKING & VAN ACCESSIBLE PARKING DETAIL

SCALE: 1/8" = 1'-0"

2 ACCESSIBLE PARKING SIGNAGE DETAIL

NOT TO SCALE

3 ACCESSIBLE PARKING COUNT TABLE & PARKING NOTES

NO SCALE

4 ACCESSIBLE PASSENGER DROP-OFF DETAIL

SCALE: 1/8" = 1'-0"

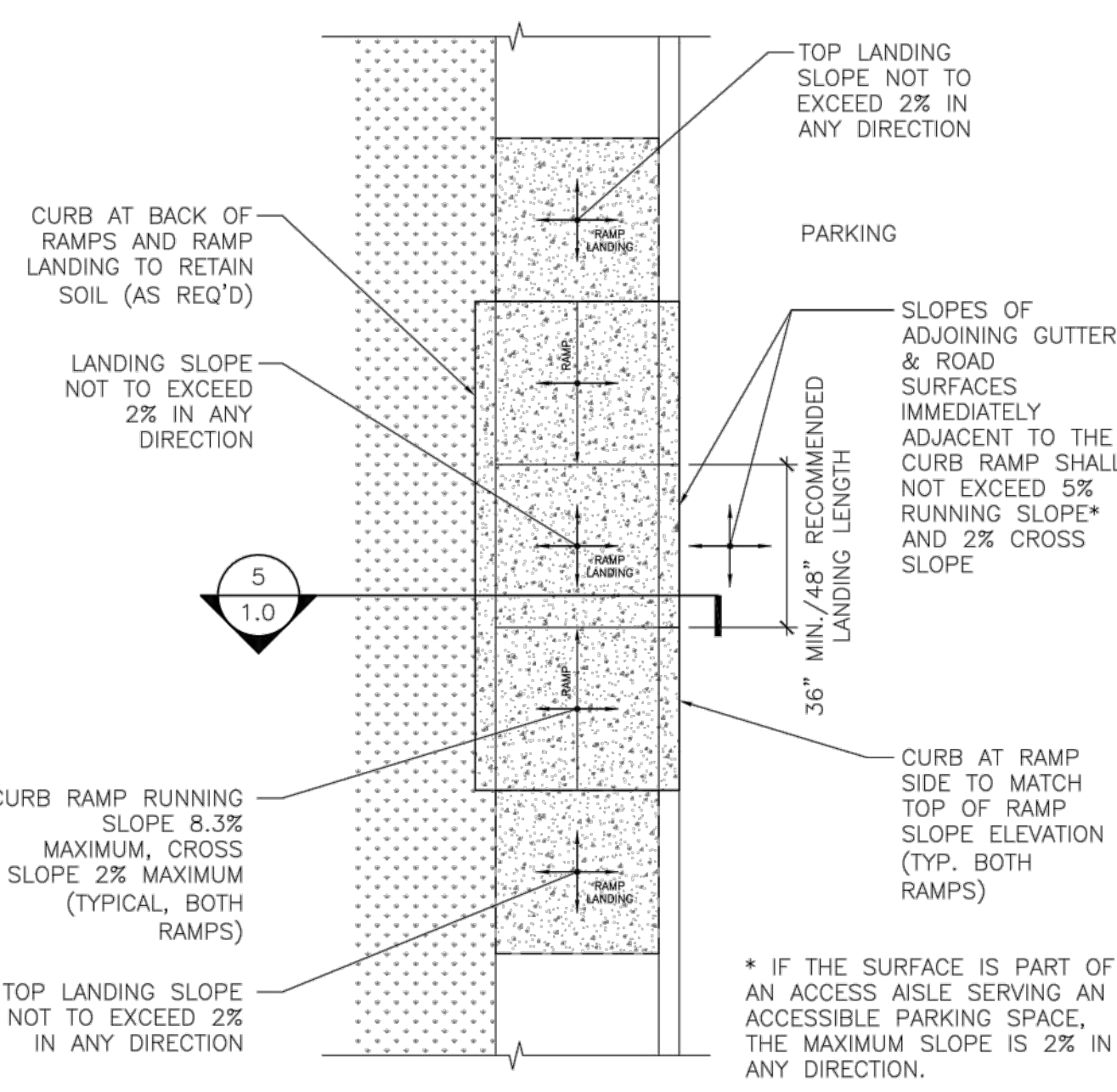
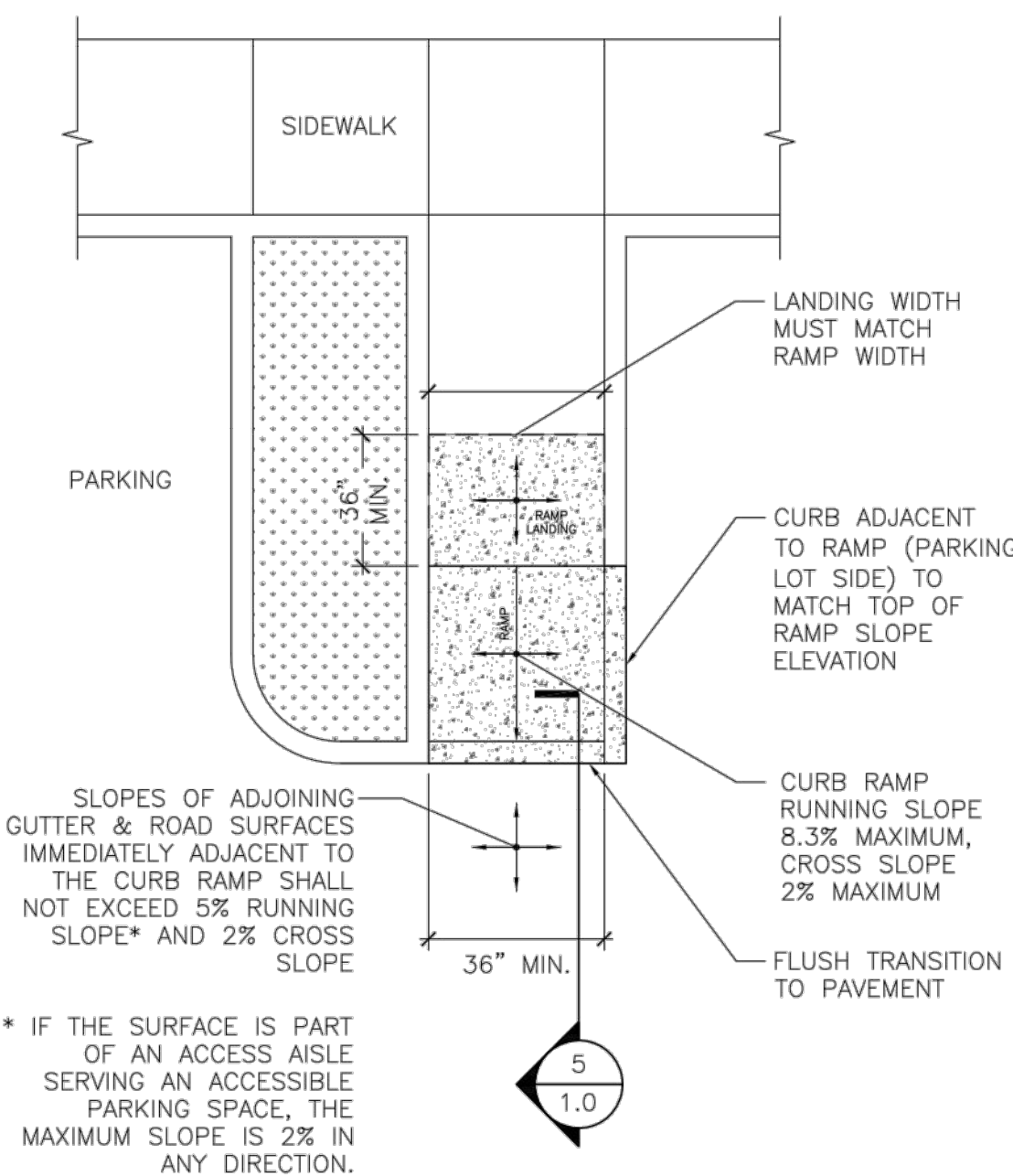
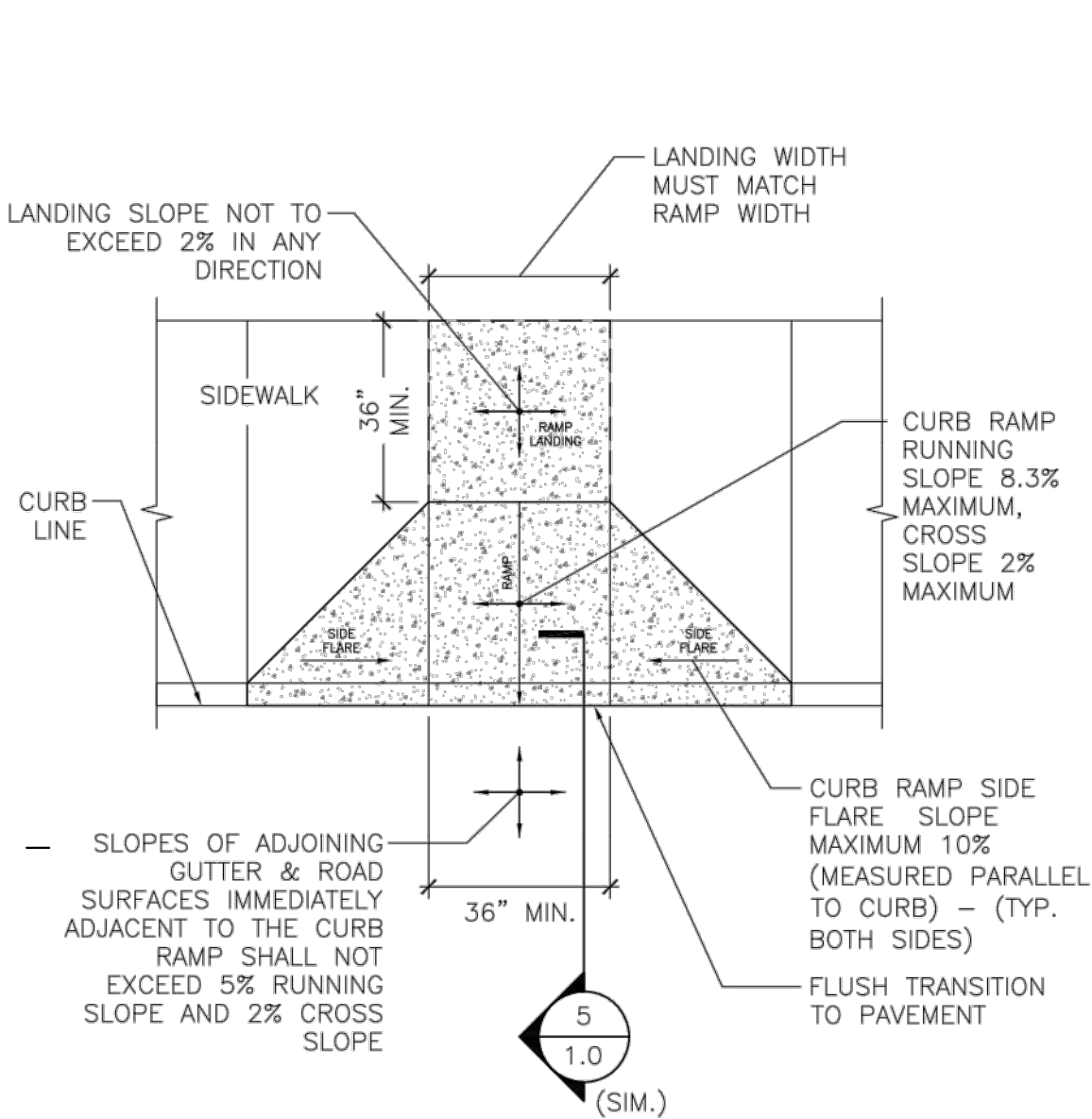

NOTES:

1. ALL STEPS ON A FLIGHT OF STAIRS SHALL HAVE UNIFORM RISER HEIGHTS AND TREAD DEPTHS. RISERS SHALL BE 4 INCHES HIGH MINIMUM AND 7 INCHES HIGH MAXIMUM. TREADS SHALL BE MINIMUM 11 INCHES DEEP MEASURED FROM RISER TO RISER.
2. OPEN RISERS SHALL NOT BE PERMITTED.
3. RADIUS OF CURVATURE OF THE LANDING EDGE OF THE TREAD SHALL BE 1/2" MAXIMUM. RISERS SHALL BE PERMITTED TO SLOPE UNDER THE TREAD AT AN ANGLE OF 30 DEGREES MAXIMUM FROM VERTICAL. THE PERMITTED PROJECTION OF THE NOSING SHALL BE 1-1/2" MAXIMUM BEYOND THE TREAD BELOW. SEE 2010 ADA STANDARDS 504.5.
4. HANDRAILS SHALL BE PROVIDED ON BOTH SIDES OF STAIRS.
5. HANDRAILS SHALL BE CONTINUOUS WITHIN THE FULL LENGTH OF EACH STAIR FLIGHT.
6. TOP OF GRIPPING SURFACES OF HANDRAILS SHALL BE A MINIMUM 34" AND MAXIMUM 38" VERTICALLY ABOVE STAIR NOSING. HANDRAILS SHALL BE A CONSISTENT HEIGHT ABOVE STAIR NOSING.
7. CLEAR SPACE BETWEEN HANDRAIL AND ADJACENT SURFACES SHALL BE 1-1/2" MINIMUM.
8. HANDRAILS SHALL HAVE A CIRCULAR CROSS SECTION WITH AN OUTSIDE DIAMETER OF 1-1/4" MINIMUM AND 2" MAXIMUM, OR SHALL PROVIDE EQUIVALENT GRASPABILITY.
9. AT THE TOP OF A STAIR FLIGHT, HANDRAILS SHALL EXTEND HORIZONTALLY ABOVE THE LANDING 12" MINIMUM BEGINNING DIRECTLY ABOVE THE FIRST RISER NOSING.
10. AT THE BOTTOM OF A STAIR FLIGHT, HANDRAILS SHALL EXTEND AT THE SLOPE OF THE STAIR FLIGHT FOR A HORIZONTAL DISTANCE EQUAL TO ONE TREAD DEPTH BEYOND THE LAST RISER NOSING. SUCH EXTENSION SHALL CONTINUE WITH A HORIZONTAL EXTENSION OR SHALL BE CONTINUOUS TO THE HANDRAIL OF AN ADJACENT STAIR FLIGHT OR SHALL RETURN TO A WALL, GUARD, OR THE WALKING SURFACE.

5 BOTTOM OF CURB RAMP DETAIL

NOT TO SCALE

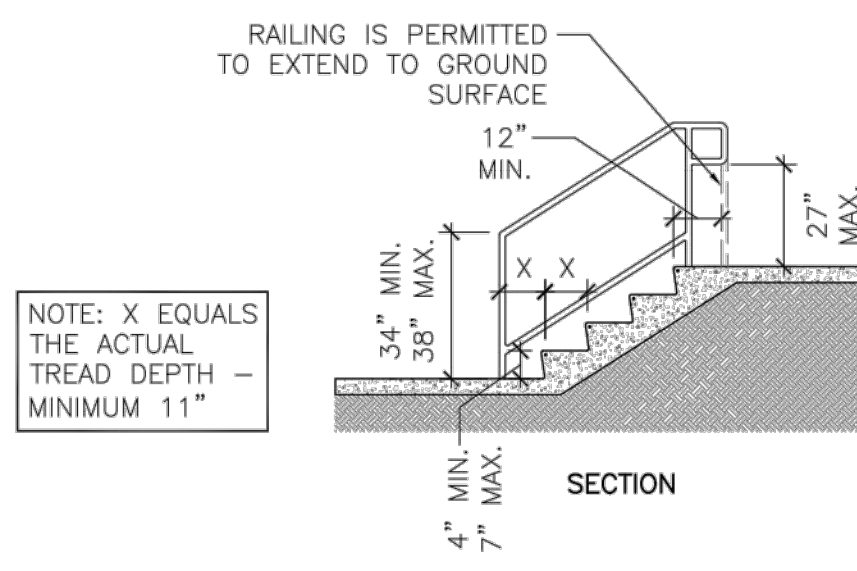

6 PERPENDICULAR CURB RAMP DETAIL

SCALE: 1/4" = 1'-0"

7 PERPENDICULAR CURB RAMP AT PARKING ISLAND DETAIL

SCALE: 1/4" = 1'-0"

8 IN-LINE CURB RAMP DETAIL

SCALE: 1/4" = 1'-0"

9 STAIR & STAIR HANDRAIL DETAIL

SCALE: 1/4" = 1'-0"

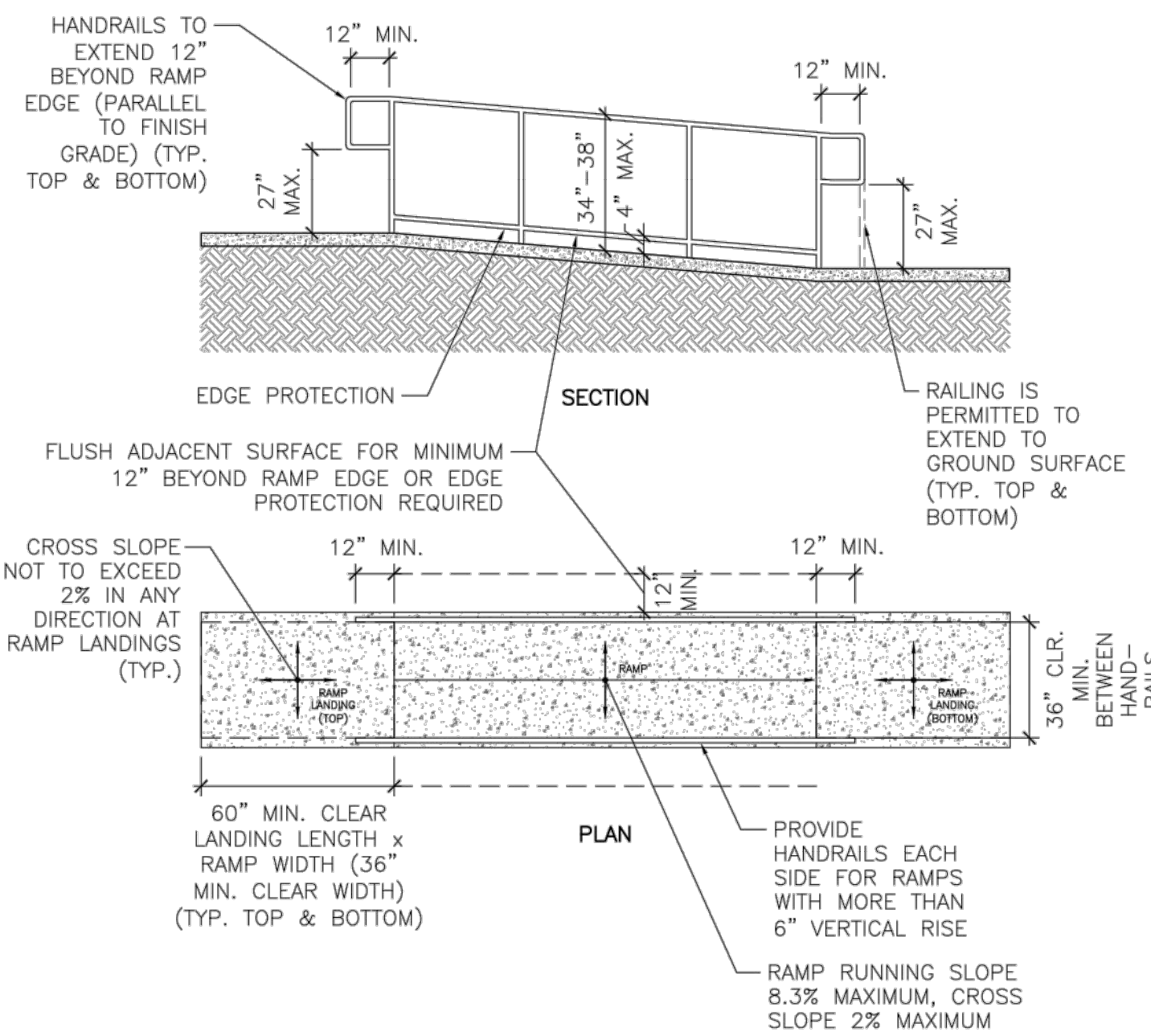

RAMP NOTES:

1. THE MAXIMUM RISE FOR ANY RAMP RUN IS 30 INCHES.
2. RAMPS SHALL HAVE A LANDING AT TOP AND BOTTOM OF EACH RUN.
3. RAMPS THAT RISE MORE THAN 30" MUST HAVE INTERMEDIATE LANDINGS AS REQUIRED TO MAINTAIN MAXIMUM 30" RISE FOR EACH RAMP.
4. RAMPS THAT CHANGE DIRECTION AT LANDINGS SHALL HAVE A 60"x60" MINIMUM LEVEL LANDING.
5. REFER TO DETAIL 10/1.0 FOR HANDRAIL REQUIREMENTS.
6. OUTDOOR RAMPS AND APPROACHES TO RAMPS SHALL NOT ACCUMULATE WATER ON WALKING SURFACES.
7. PROVIDE RAMP SURFACE THAT IS FIRM, STABLE AND SLIP RESISTANT.

RAMP HANDRAIL NOTES:

1. HANDRAILS SHALL BE PROVIDED ON BOTH SIDES OF RAMP AND CONTINUOUS ON RUNS OF RAMPS.
2. INSIDE HANDRAILS ON SWITCH BACK OR DOGLEG RAMPS SHALL BE CONTINUOUS BETWEEN RUNS.
3. TOP OF HANDRAIL TO BE AT 34" MIN. TO 38" MAX. ABOVE FINISHED GRADE AT A CONSISTENT HEIGHT THROUGHOUT.
4. HANDRAILS SHALL HAVE A CIRCULAR CROSS SECTION WITH AN OUTSIDE DIAMETER OF 1-1/4" MINIMUM AND 2" MAXIMUM.
5. CLEARANCE BETWEEN HANDRAIL GRIPPING SURFACE MUST BE 1-1/2" MINIMUM IF ADJACENT SURFACE (I.E. WALL) IS PRESENT (SURFACE TO BE FREE OF ANY SHARP OR ABRASIVE ELEMENTS).
6. RAMP HANDRAILS SHALL EXTEND HORIZONTALLY ABOVE THE LANDING FOR 12" MIN. BEYOND THE TOP AND BOTTOM OF RAMP RUNS. EXTENSIONS SHALL RETURN TO A WALL, GUARD, OR THE LANDING SURFACE, OR SHALL BE CONTINUOUS TO THE HANDRAIL OF AN ADJACENT RAMP RUN.
7. RAMPS WITH AN OVERALL RISE OF 6" OR LESS DO NOT REQUIRE HANDRAILS.

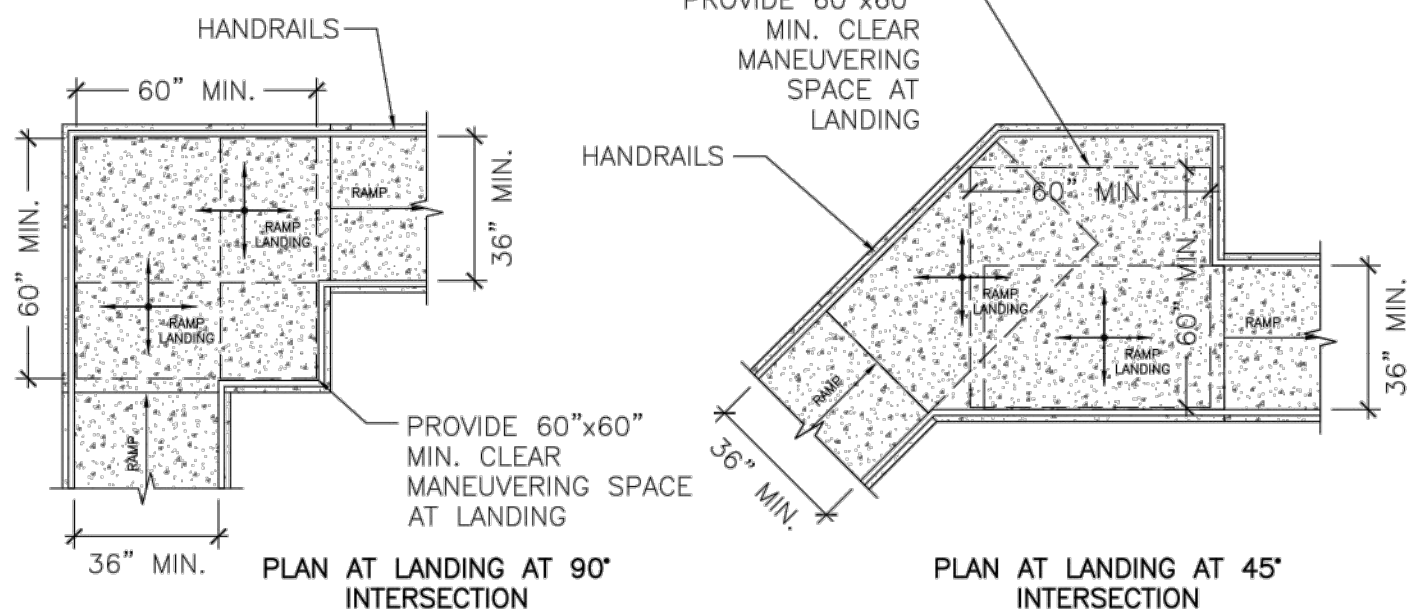

11 ACCESSIBLE ROUTE CLEAR WIDTH AND SLOPE DETAIL

1.0

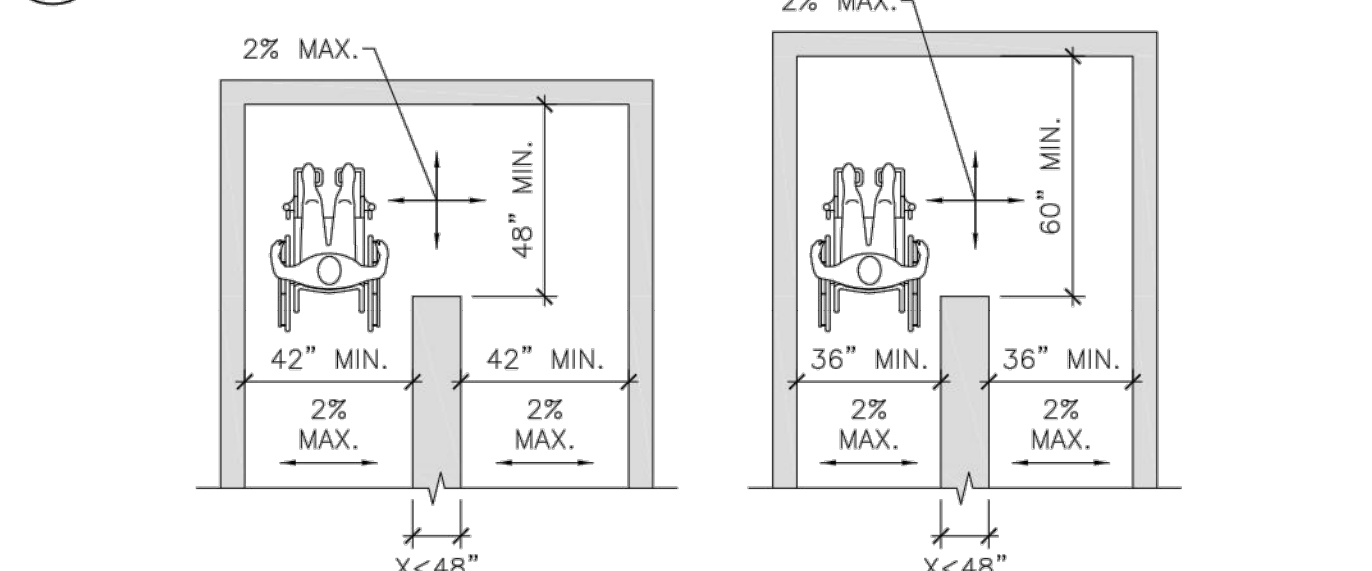

12 ACCESSIBLE ROUTE CLEAR WIDTH AT TURN (AROUND OBSTRUCTION) AND SLOPE DETAIL

1.0

13 VERTICAL LEVEL CHANGE ON ACCESSIBLE ROUTE DETAIL

1.0

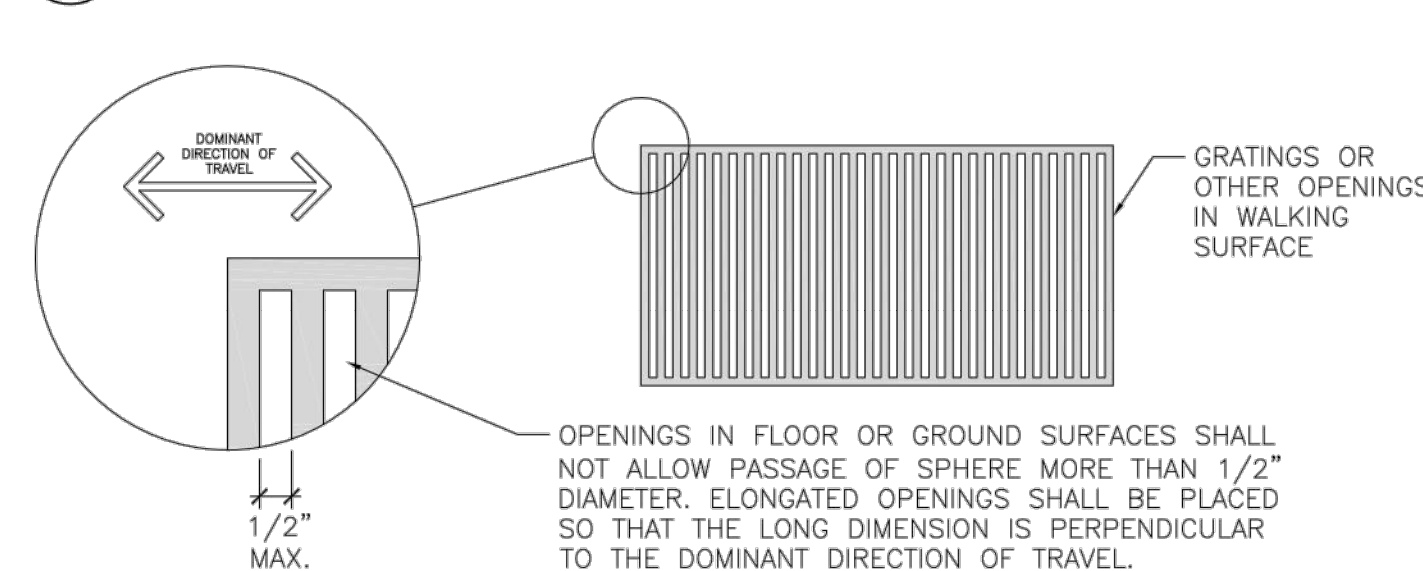

14 GAP OR OPENING ON ACCESSIBLE ROUTE DETAIL

1.0

NOT TO SCALE

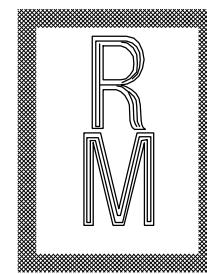

Richard Molenaar

ARCHITECT

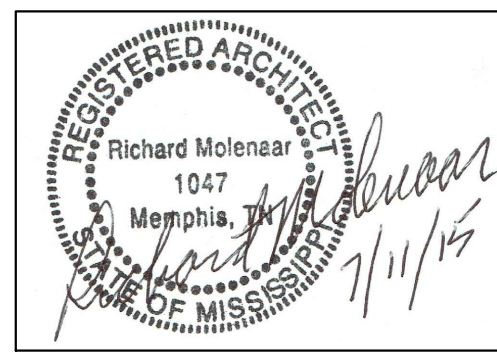

PROJECT NAME:

HOME2
SUITES BY HILTON

Old Fannin Road Flowood, Mississippi

SHEET TITLE:

Accessibility Guidelines

PROJECT NO.

LATEST REVISION:

DRAWN BY:

CHECKED BY:

SHEET NUMBER:

DATE:

July 11, 2015

ADA-1.0